

# KIT WIRELESS

## USER MANUAL

### KIT7WBR

7-inch monitor kit + magnetic wireless rear view camera with built-in battery



# MACROM

# Installation

- Before completing the installation, temporarily connect the wiring and make sure it works properly.
- Use only the parts included with the unit to ensure proper installation. Using parts not included in the package may cause malfunctions.
- This product must be installed by an authorized reseller to qualify for warranty.
- Install the unit in a location that will not harm the driver or passenger to avoid collision in the event of a sudden stop such as an emergency stop.
- Avoid installing the unit in places subject to high temperatures, such as direct sunlight, hot air, or where it would be subject to dust dirt or excessive vibration.
- Be sure to remove the front protective film after installing the unit.

## Monitor setup

Choose the position of the monitor in the vehicle so that it does not block your view and complies with local laws for safe driving.

1. Dashboard
2. Support

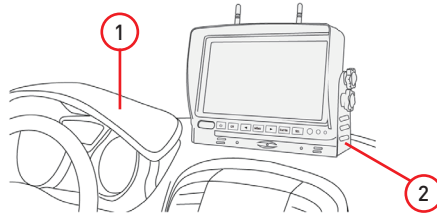

**Note:**

Before drilling the holes in the dashboard necessary for fixing the U-shaped support, make sure there are no obstacles such as ventilation pipes underneath or electrical wiring.

## Magnetic camera installation

Choose the position of the camera on the vehicle and make sure that the surface on which it will be placed is metal.

To ensure proper adhesion, do not place the camera on uneven or rough surfaces.

However, it is good practice to clean the surface before applying the magnetic camera.



# Connections

## Wifi Antennas

1. Connect the Wifi antennas paying attention to the operating frequency indicated on the antenna ( A ), 2.4 Ghz, ( B ), 433 Mhz,

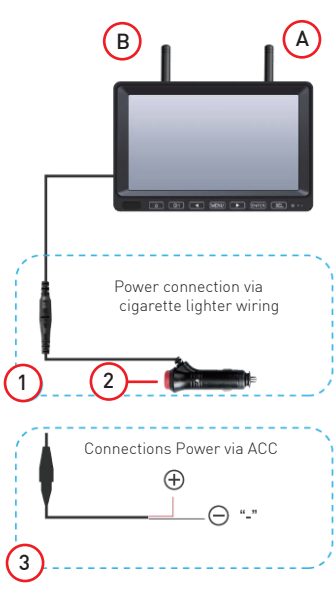

## Power Supply

1. Connect the monitor harness to your vehicle's cigarette lighter.
2. Press the [Power] button on the top of the cigarette lighter to turn the monitor on or off.
3. As an alternative to the cigarette lighter wiring, a direct connection can be made to the car's ignition switch. Make sure there is a 10 Ampere protection fuse.
4. To charge the battery of the camera it is necessary to connect the USB type C to a charger with an output voltage of DC 5V and a current of 2A.

NOTE: Before using the camera, make sure it is fully charged. Charging time may vary depending on the actual charge of the product. Maximum recharge time about 9 hours. The battery charger is not supplied.

## Power button and charging indicators

2. On the side of the camcorder you will find the Power button and battery charge indicators
3. Power button (On/Off)
4. Battery charge indicators 25%-50%-75%-100%

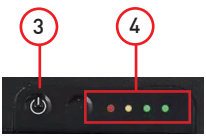

# Product overview

## Front panel

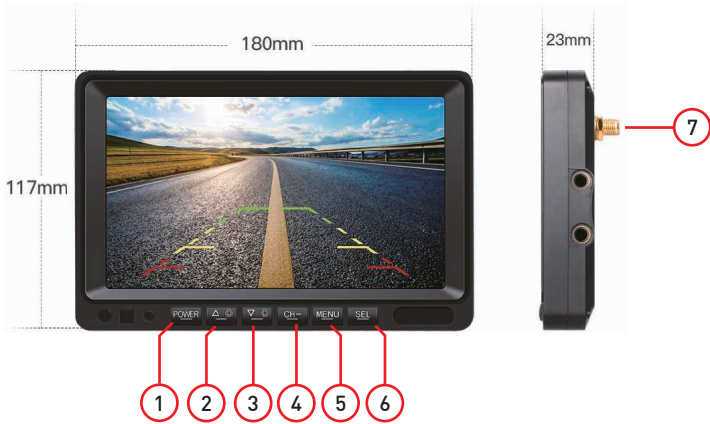

Warning:  
The images in this manual are indicative only and may differ from the actual product. Please refer to the actual device unit.

1. Power Key (On/Off)
2. Key Previous / Decrease brightness
3. Key Next / Increase brightness
4. Rear view camera channel selection key
5. Menu key
6. SEL / Record & Stop key
7. Wi-Fi antennas

## Remote control

1. Start button for Recording / Stop (Note: SD card is required to be inserted)
2. Power key
3. Guidelines shortcut key
4. - Decrease brightness  
- Key Previous
5. Menu access key
6. - Increase brightness  
- Key Next
7. - Change channel  
- CH1---CH2---CH3---CH4 (Screen split)
8. Displays the CH1 channel screen
9. Displays the CH3 channel screen
10. Displays the CH2 channel screen
11. Displays the CH4 channel screen

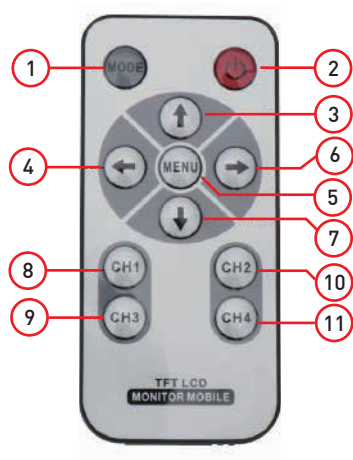

# Rear view camera pairing

## Important

Before proceeding with the use of the monitor it is necessary to pair a rear view camera using the pairing function.

**Note**  
Before using and pairing the camera make sure it is fully charged.  
Charging time may vary depending on the actual charge of the product.  
Maximum recharge time about 9 hours

1. Using the key (CH) select the channel to which you want to connect the camera.



2. Enter the menu and select PAIRING to pair.  
Press the SEL key to confirm the procedure.



3. The monitor shows the pairing procedure via "countdown" on the screen

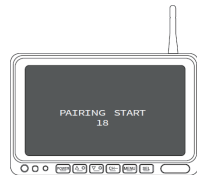

4. At the end, the image of the previously paired camera will be displayed.



**NOTE:**  
If you need to pair more cameras, please repeat the above procedure again selecting the corresponding channel.

# Video Recording / Playback

## Insert an SD card

Using a Phillips screwdriver, open the SD card door on the back of the monitor and insert the SD card. It is recommended to use a class 10 high-speed TF card (minimum) or higher. Maximum allowed capacity of 128Gb.



## Recording mode

Before proceeding with the recording it is necessary to format the new SD card.

Select the Recording mode using the cursor </> and confirm the "Format" selection by pressing the SEL key. Confirm again to format the SD cards.

To make a recording, press the SEL key, a flashing red dot ● appears on the screen

To end the recording, press SEL again.



### Note:

When the SD is inserted, the symbol appears on the screen  which confirms the presence of the SD card. If the symbol turns out to be red, the class of the SD does not comply with the specific requests of the product.

### Note:

The recording of the video signal relates only to the image of the camera/s displayed on the screen. If you want to make multiple recordings, you need to display multiple cameras on the screen at the same time so that the monitor can simultaneously record multiple channels.

## Circular Registration

If you want to overwrite the entries, you must activate the "Circular logging" function.

Select the Recording mode using the cursor </> and confirm the selection "Circular recording" by pressing the SEL key and confirm again to activate the function.

### Note:

When the function is active, the symbol  appears on the screen to confirm that overwriting has been activated.

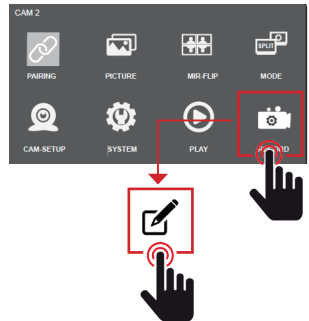

## Video playback

If you want to view the recordings you need to access the Play function. The video list will be shown in sequence of date and time of recording.

### Note:

Each recording segment has a maximum duration of 60 seconds.  
Each file is approximately 4 megabits in size.

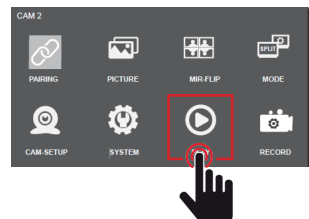

## System settings

### Image settings

Access the menu and select image using the cursor </> and confirm the selection using the SEL key.

Select the Brightness / Contrast / Color functions using the cursor </> and confirm your selection by pressing the SEL key.

Modify the desired value of the selected function and press menu to exit the configuration.



### Image rotation

Enter the menu and select Mirrors using the cursor </> and confirm the selection using the SEL key.

Select the rotation of the desired image using the cursor </> and confirm the selection by pressing the SEL key. Press menu to exit setup.

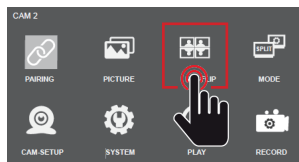

### Split mode setting

Enter the menu and select Mode using the cursor </> and confirm the selection using the SEL key.

Select the viewing mode of the screen with the images you wish to view using the cursor </> and confirm your selection by pressing the SEL key.

Press menu to exit setup.

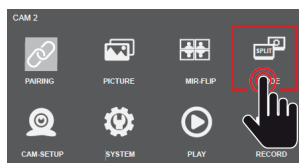

### Impostazione della fotocamera

Enter the menu and select Mode using the cursor </> and confirm the selection using the SEL key.

Select the viewing mode of the screen with the images you wish to view using the cursor </> and confirm your selection by pressing the SEL key.

Press menu to exit setup.

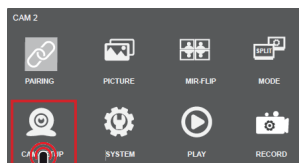

Note: it is possible to set the automatic rotation cycle of the display (1-2-3-4) and the desired time.

### System setup

Access the system settings and select image using the cursor </> and confirm the selection using the SEL key.

Select the functions: Date-Time / Language / Trigger / Guidelines / System Reset using the cursor </> and confirm your selection by pressing the SEL key.

Modify the desired value of the function select and press menu to exit the configuration.

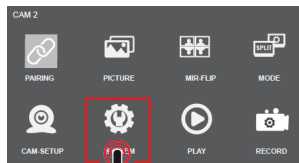

Note it is possible to set the automatic rotation cycle of the display (1-2-3-4) and the desired time.

## Specifications

---

### Monitor

Screen .....	7" AHD IPS
Resolution .....	1024xRGB*600P
Contrast .....	600:1
Power Supply .....	DC12V-36V
Maximum current level .....	10A
System.....	PAL/NTSC (AUTO)
Connection .....	WiFi

### Registration

Mode.....	QUAD-Vision 4 retrocamera
Video .....	Mp4
Images.....	JPG

### Support

Typology .....	Full SD HC/XC
Maximum capacity.....	128Gb
Speed .....	Class 10 (minimum)
Bus SD.....	UHS-I
Category .....	High Endurance

#### Note:

The Endurance category guarantees a greater amount of overwriting than traditional SD.

### WiFi

Integrated Wi-Fi.....	2.4G wireless
Network range .....	2403-2480MHz
Distance .....	≤ 200m in open field

### Camera

Sensor .....	1/3" AHD
Resolution .....	1280*720P
Viewing angle.....	110°[H] 140°[D]
Waterproof .....	IP68
Night lighting .....	IR (infrared)
Night vision distance .....	5 meters

### Battery

Battery capacity .....	6700mAH
Charging time .....	9 ore
Operating time .....	16 ore
Charging power supply.....	USB Type-C
Type of battery charger .....	DC 5V - 2A
Battery charge indicators .....	25%-50%-75%-100%
Installation .....	By magnet wrapped with rubber case



w w w . m a c r o m . i t