

RECEIVER MULTIMEDIA

USER MANUAL
M-DL6800DAB



DAB+
Digital Audio Broadcasting

MACROM

Contents

Contents	2	iPod / iPhone	11
Safety Precautions	3	Connections	11
Installation / Removal	4	UI overview	11
Microphone	4	Bluetooth	12
Radio unit installation	4	Device association.....	12
Removing the radio unit	4	USB	13
Warning	5	Content Search	13
Precautions	5	Audio file overview	13
Parking brake	5	Video file overview	13
Product overview	6	Settings	14
Front panel	6	Audio	14
Basic operations	7	View	14
Power On / Off	7	Tuner	14
Volume adjustments	7	General	14
Mute	7	SWC	14
Source selections	7	SWC programming	15
Screen dimmere mode	7	Miscellaneous	15
AM / FM / DAB radio	8	Additional devices	15
Radio mode	8	Reset	15
Radio band selection	8	Fuse replacement	15
Tuning	8	Audio Control	16
TA functions	8	Equalizer menu	16
DAB radio	9	Audio Effects Preset	16
Service following	9	Equalizer parameters	16
PTY function	9	Fader and Balance	16
AutoLink Android	10	Specifications	17
Connection procedure	10	Connections	18

MACROM

Safety Precautions

Thank you for purchasing this product. Please read through these operating instructions so you will know how to operate your model properly. After you've finished reading the instructions, keep this manual in a safe place for future reference.

Only connect the unit to a 12-volt power supply with negative grounding.

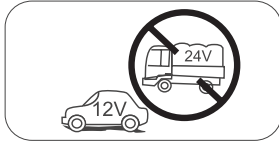

Never install this unit where the operation & condition for safe driving is impaired.

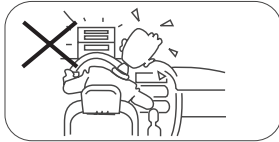

Never use the video display function in the front when driving to prevent the violation of laws & regulations and also to reduce the risk of traffic accident except for using rear view video camera.



Never expose this unit, amplifier, and speakers to moisture or water to prevent electric sparks or fire.

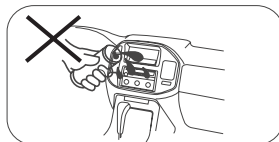

Please don't change the fuse on the power cord without professional guidance, using improper fuse may cause damage to this unit or even cause fire.

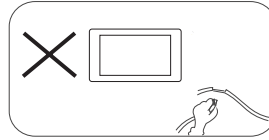

Please contact your nearest dealer if one of the following symptoms is experienced:

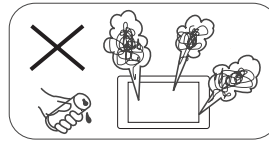

- (a). Water or other objects enters the unit.
- (b). There is smoke.
- (c). Peculiar smell.

To ensure safe driving, please adjust the volume to a safe and comfortable level in case of emergency situations.

Installation / Removal

Microphone installation

1. Place the microphone on the side of the rear view mirror or on the side of the sun visor.
2. Connect the microphone jack to the unit by fixing the cable in multiple positions using adhesive tape or cable ties to an existing wiring to ensure correct routing.

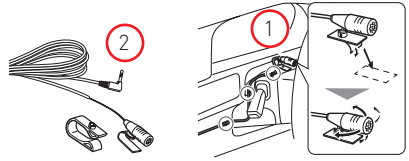

Radio unit installation

1. Insert the metal cage into the radio compartment of the car and bend the fixing tabs with a screwdriver to ensure proper tightening.
2. To complete the installation, apply the finishing frame on the radio body.

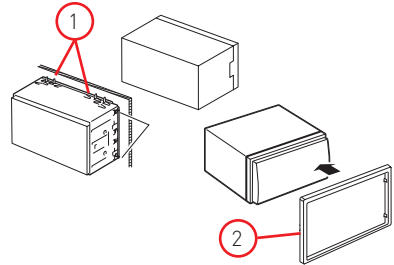

Removing the radio unit

1. Remove the finishing frame with plastic palette, press lightly on all four sides to be able to extract the frame.

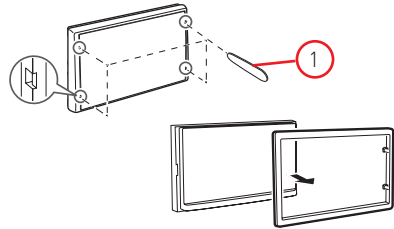

2. Insert the keys to extract the radio unit into the appropriate slot.

Pull out the radio unit halfway and pay attention to avoid injury to the locking pins on the extraction key.

Fully extract the unit with your hands, being careful not to drop it.

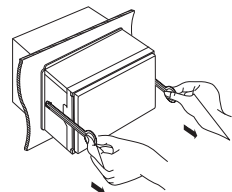
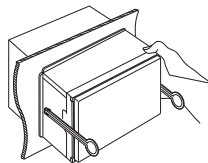
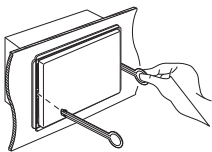
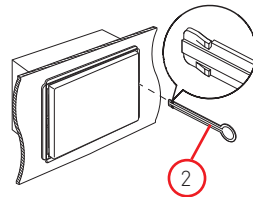

Warning

Precautions

1. Never disassemble or adjust the unit without any professional guidance.
For details, please consult any professional car shop / dealer for inquiry.
2. If the front panel or TFT monitor is dirty, please use a clean silicone cloth and neutral detergent to wipe off the spot. Using a rough cloth and non-neutral detergent such as alcohol for cleaning may result in scratching or decoloration to the monitor.
3. If any abnormal behavior of the unit is found, please refer to trouble shooting guide of this manual. If no relevant information is found, please press the [RESET] key on the front panel to resume factory default.
4. If you have parked the car in hot or cold weather for a long time, please wait until the temperature in the car becomes normal before operating the unit.
5. Using the car heater in low temperature environment may result in moisture inside the unit, DO NOT use the unit in this situation. Eject the disc and wipe off the moisture on the disc. If the unit still doesn't work after a few hours, please contact the service center.
6. Do not impact the LCD monitor which could cause damage.
7. To prevent damage to the screen, avoid touching it with sharp objects.
8. To provide a clear demonstration and an alternative for easy understanding to the operation of this unit, graphic illustrations are used.
However, some illustrations are different from the actual images displayed on the screen.
9. Operate the unit correctly according to this manual to prevent unnecessary problem. The guarantee won't be valid if the problem is caused by inappropriate operation.

Detect parking brake

- In order to be able to install the android application, the handbrake connection must be connected. Engage the parking brake for APP installation.
- Connect the cable "BRAKE" to the parking brake switch to view video files on the TFT monitor. Engage the parking brake for viewing videos.
- When the parking brake is not engaged, the monitor displays "Warning!!!, Video playback is disabled for your safety. Engage parking brake to watch video.", preventing the driver to watch content while driving. The rear screens are not interested in this inhibition.

Importante note:

This connection is indispensable for the proper operation.

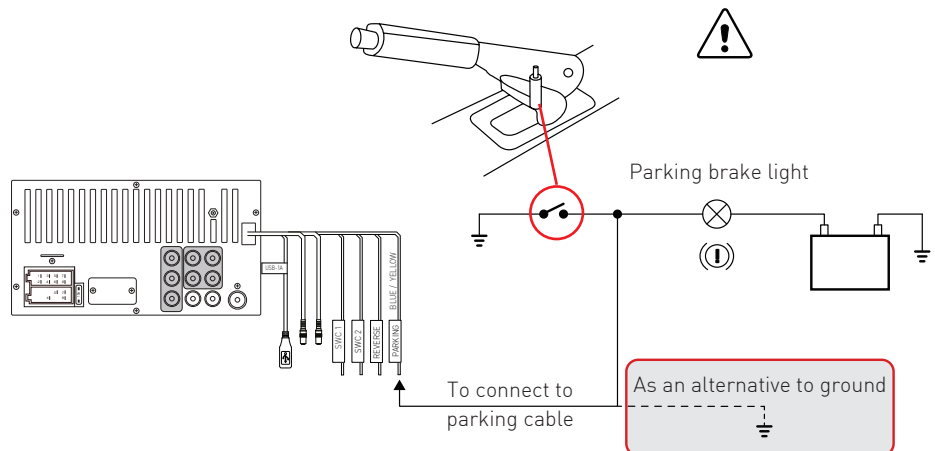





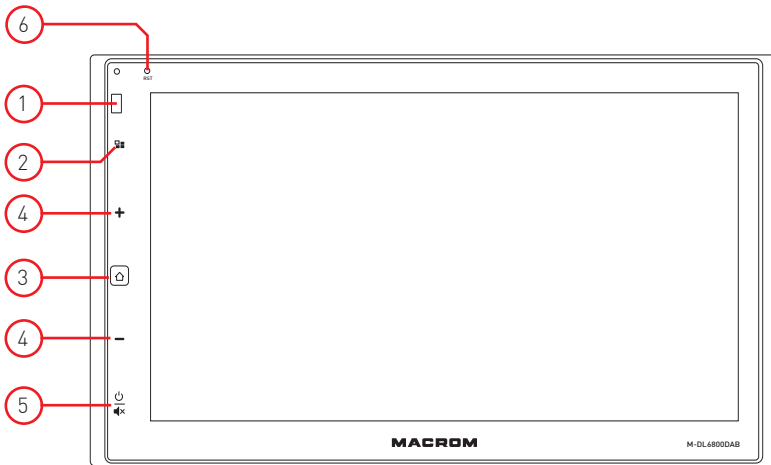

Product overview

Front panel



Notice:
The graphic in this manual is for reference only, and may be different from the actual unit.

1. IR sensor for remote control receiver
2. [] Sources button
Press the source button to switch modes.
3. [] Home button
Press the Home button to display the main menu.
Press the button again to return to the previous mode.
4. Volume +/- [ / ] button
Volume adjustment, the bar shows the desired volume level.
5. Mute / On / Off [ / ] button:
Press briefly to activate the muting function.
Hold down for a long time to turn on / off the radio unit
6. RESET button
Press to restore system settings to factory defaults.

Basic Operations



Power On / Off

Press the [] button on the unit to turn on the unit. The buttons on the front of the unit light up and the status of the current mode is displayed on the LCD.

Press and hold [] to turn off the unit.

Volume Adjustment

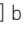
You can adjust the volume in increments from 0 (off) to 50 (maximum).

Press the [] button to increase the volume level, press the [] button to decrease the volume level.

Mute

Briefly press the [] button to mute the device or unmute the previous volume.

Selezione delle sorgenti

Press the [] key on the front panel to display the main menu.

The playback mode is displayed on the screen.

1. Date display
2. Time display.
3. Function icons.

1- Date

To set the date, access the function Time settings in the general menu.

2- Radio

Radio mode (DAB-FM-AM)

3- Bluetooth

Hands-free Bluetooth mode

4- USB

USB audio / video file playback mode

5- Mobile Link

Mobile device mirroring mode
Android connected to the device.

6- BT Audio

Audio streaming mode via the Bluetooth function of the mobile device connected to the unit.

7- Audio Video Input

Auxiliary Audio-Video mode

8- Settings

Settings related to product operation.

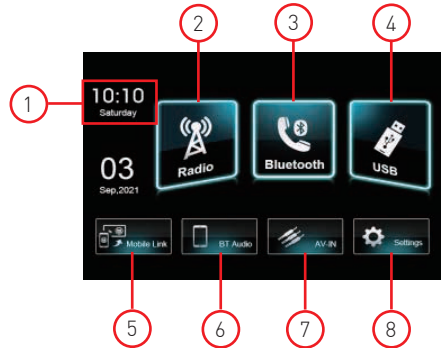

Screen dimmer mode

Press the [] dimmer button to adjust the brightness of the screen.

The available modes are; Day, Middle and Night)

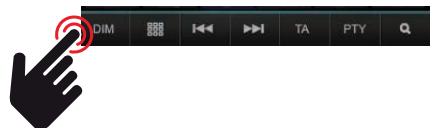

AM/FM/DAB radio

Radio overview

1. Current radio frequency / name
2. Radio presets stored.
Press and hold for two seconds to store the desired station.
3. Keyboard to directly type the frequency of the desired station.
4. Press to tune to the next or previous station.
5. TA traffic information
Press TA to activate the traffic information function.
If a broadcaster is broadcasting traffic information, the unit can reproduce the news
6. PTY selection of the type of radio program.
7. Automatically searches for stations.
8. AM / FM / DAB Band Change
Press FM to access the sections: FM1 / FM2 / FM3
Press AM to access the sections: AM1 / AM2
Press DAB to access the sections: DAB1 / DAB2 / DAB3



Radio mode

Open the main menu and select [Radio].

Radio band selection

Touch the desired band icon on the UI to cycle through the radio bands between AM, FM, DAB.

Tuning

Automatic tuning

During auto tuning, the frequency will be searched automatically.

Touch the [◀] / [▶] key on the user interface to tune in a previous or next station.

Note: When a station is received, the search stops and the station is played.

TA functions

The TA (Traffic Announcement) function allows the unit to receive traffic information automatically. The TA function can be activated by a TP (Traffic Program) station that broadcasts traffic information.

When the TA function is activated and a traffic announcement is received, the current playback source will be switched with the traffic announcement.

The unit returns to the original source after the traffic announcement has been received.

DAB radio

Tuning

Automatic tuning is required for the first installation.

Touch the [◀◀] / [▶▶] key on the user interface to tune in a previous or next station.

Note: When a station is received, the search stops and the station is played.

FM service following

If the DAB frequency is not present it will automatically switch to the corresponding station in the FM range. (See note 1)

1. The DAB signal indicator displays the level of the received signal in real time.

Excellent level	
Fair level	
Good level	
Poor level	
Absent level	

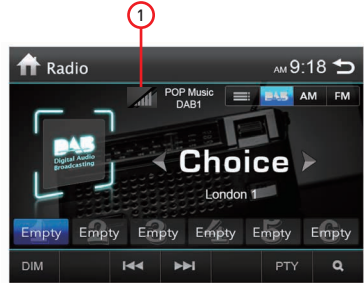

Note :

The "FM Service following" service receives broadcasters with the same identification and name as the broadcaster in FM mode. If the station received in DAB mode is not present in the FM range, the device will not be able to provide the alternative service.

2. PopUp automatic scan (AUTOSTORE)

The device readies itself for automatic scanning when the (🔍) button for automatic search is pressed.

Confirm the automatic scan with the (✓) key or press (✗) if you want to cancel the scan.



PTY function

PTY is the abbreviation for the type of program defined by a code to define the program being broadcast (for example news or Rock).

PTY Options are displayed on the screen. To view the PTY options, tap the scroll bar and arrows on the screen.

When a PTY option is selected (eg News), the radio unit searches for the available PTY program.

If the required PTY was not found, the unit returns to the original radio frequency.

AutoLink Android

The AutoLink function allows you to connect an Android mobile phone via the USB line, using the mirror method, the mobile phone screen will be displayed on the vehicle. The device can be managed from the screen of the radio unit and the connection is made automatically, convenient and safe, to use the mobile phone.

Note:

AutoLink application only supports Android system from version: 5.0
Access the Google store to download the AutoLink application or via QR code.
Android AutoLink must be installed on the phone before connecting.
The connection must be unblocked from the connected device.
Bluetooth must be connected to have audio output.

Connection procedure

- Connect the Android phone via the USB cable provided with the device.
- Open the phone developer options interface and enable USB debugging.
- Press "Connect Phone" in the user interface to connect the phone.
- Confirm authorization to connect the USB accessory on the phone.



IMPORTANT NOTE:

The PARKING service file of the device must be linked with the handbrake of the vehicle.

iPod/iPhone

Connections

To connect, use the Lightning USB cable supplied with the iPod / iPhone package, or an Apple-certified USB audio / data cable.

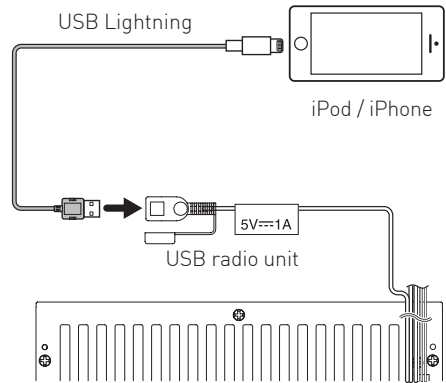

iPod / iPhone overview

1. Cover
(shown if contained in the audio track)
2. Time scroll bar.
3. [▶||] button for Play and / or Pause of the track.
Touch the [◀◀] / [▶▶] key on the user interface to edit the previous or next track.
4. Repeat the current track [↺]
5. Causal reproduction of the traces [↻]
6. Current track information
7. Search for content
8. Reproduction status



Bluetooth

Through the unit, you can make or receive calls with Bluetooth-enabled phones. You can also listen to music from a Bluetooth device, the source is stopped and the call menu is displayed.

Bluetooth device pairing

If you want to connect a device to the audio system for the first time, you need to access the Bluetooth function of your device.

1. Activate the Bluetooth function on your device.
2. Start the scan on the Bluetooth device and select the "M-DL6800DAB" unit
3. If requested, enter the access code 0000, or confirm the access code automatically proposed for pairing the devices.
The connection is established and the menu for the registered device is displayed.

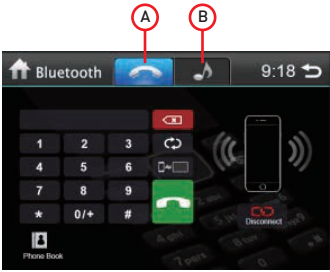

- A. Bluetooth hands-free function.
- B. A2DP audio streaming function.



1. Receiving incoming calls.
2. Synchronization of the phone book.
3. Associated device disconnection

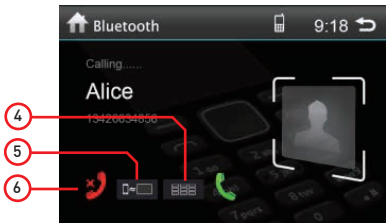

4. Keypad for sending tones and confirming numbering.
5. Switches the voice output between the mobile phone and speakers.
6. End the call.

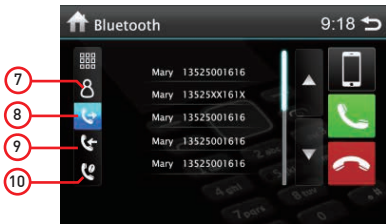

7. Phone book.
8. Outgoing call log.
9. Incoming call log.
10. Missed call log.

USB

Content search

1. Audio files / tracks.

Press [🎵] to view all available audio files.

Press [D: /] to view all available audio folders.

2. Pictures

Press [🖼️] to view all available images.

Press [D: /] to view all available picture folders.

3. Video files

Press [🎬] to view all available videos.

Press [D: /] to view all available video folders

4. Search for available folders.

5. Cursor for scrolling files or folders



USB audio file overview

1. Cover

[shown if contained in the track]

2. Time scroll bar.

3. [▶] button for Play and / or Pause of the track. Touch the [⏮] / [⏭] key on the user interface to edit the previous or next track.

4. Repeat the current track [🔄]

5. Causal reproduction of the traces [🔗]

6. Current track information

7. Search for content

8. Reproduction status

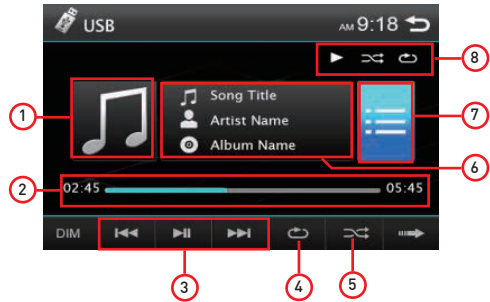

USB video file overview

1. Time scroll bar.

2. [▶] button for Play and / or Pause of the track.

Touch the [⏮] / [⏭] key on the user interface to edit the previous or next track.

3. Repeat the current track [🔄]

4. Causal reproduction of the traces [🔗]

5. Current track information

6. Next / previous page

7. Image Adjustment:

- Brightness
- Contrast
- Tint
- Color

8. Zoom (Off- x2- x3- x4- x5- x½ - x½ x¼)

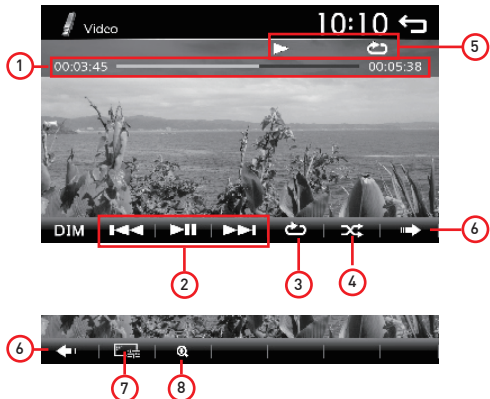

Settings

Audio

Audio Settings	Options	Description
Sound effects	Equalizzatore - Fader / Balance	Access to Audio settings
Acoustic touch	On - Off	Activate / deactivate the Beep at the touch of the screen
Loudness	On - Off	Turn the Loudness effect On / Off
Subwoofer	80Hz - 120Hz - 160Hz - Off	Subwoofer output crossover frequency settings
	Volume	Subwoofer volume output level
Reverse volume	Week - Mid - High - Off	Settings for the level of audio suppression when engaging reverse gear

View

Video settings	Options	Description
Appearance	16:9 - 4:3	Setting the video aspect of the screen

Tuner

Radio Settings	Options	Description
Stereo	On - Off	Stereo / Mono FM radio setting
Local	On - Off	Local / Distant FM radio settings
Time with RDS	On - Off	Time synchronization with FM RDS radio function
AF (alternative frequency)	On - Off	Automatic search for alternative frequencies

General

General Settings	Options	Description
Language	English Spanish French German Italian	System language setting
Auto BT connection	On - Off	Automatic connection of the phone connected to Bluetooth
Time settings	Hour - Minutes - 12/24	Time setting and 12/24 hour mode
Default		Reset to factory settings

SWC

SWC Settings	Options	Description
		Learning of the SWC functions of the vehicle

For the learning procedure follow the next page.

SWC programming

1. Enter settings and select SWC.
2. Press and hold the steering wheel button you wish to pair (for example Volume) so that an ADC: xxxx code appears on the screen
3. Pair the desired function by holding down the function icon and the steering wheel button at the same time until [Checking ...] appears, keep it pressed until [Saved] appears, indicating completion of the learning process. function. The selected key will change color to light blue indicating correct learning.
4. Repeat the step described in point 3 for all the other functions that you want to combine.
5. At the end of the pairing of all the functions, it is necessary to confirm the memorization by pressing the check button [✓] followed by the message [Successfully Saved].



6. To cancel an incorrect programming, press the trash can.

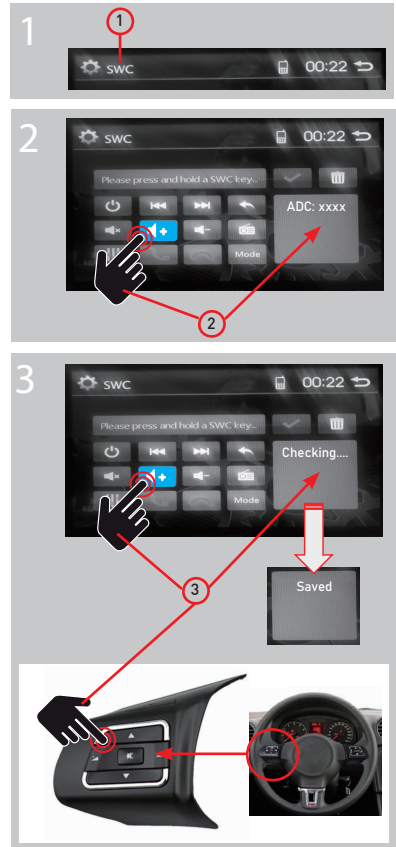
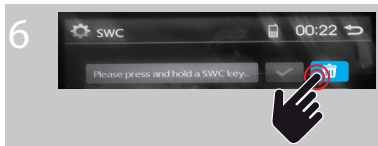

Various

Additional devices

You can connect an external audio / video device to the unit.

1. Connect the external device with the supplied AV cable.
2. Touch the top left corner to view the main menu.
3. Touch [AV-IN] to access the external device.

Reset

If the unit freezes, it is possible to reset.

Press the [RESET] button with a ballpoint pen or similar tool.

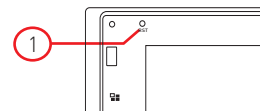

Fuse replacement

If the unit does not turn on, the fuse may be damaged and must be replaced.

1. Remove the unit from the dashboard.
2. Check all electrical connections.
3. Purchase a fuse that matches the amperage of the damaged fuse.
4. Replace the fuse making sure that the unit is disconnected from the power supply.

Audio control

Equalizer menu

The equalizer function allows you to easily adjust your audio system to the acoustic characteristics of your vehicle.

Audio Effects Preset

1. Touch the  icon in the user interface to open the EQ mode.
2. Select the desired EQ preset:
[User] - [Pop] - [Rock] - [Classic] - [Jazz] - [Vocal].











Equalization parameter settings

To adjust the EQ parameters, select the intervention point on the desired frequency.

The cursor highlights the intervention point of the level increase or decrease.

Fader and Balance Adjustment

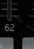
You can adjust front/back/left/right balance of the speaker and the subwoofer volume to get balanced listening effect according to the surroundings and your interest.

1. Open the EQ mode:
Touch the  icon in the user interface to display the adjustment screen.
2. Adjust the balance / fader:
Touch  /  /  /  to adjust the balance / fader value from -12 to +12.
: Front speakers
: Rear speakers
: Left speakers
: Speakers on the right

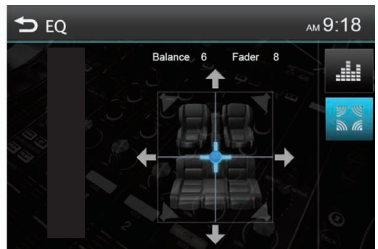

Note:

1. The EQ presets are preset and cannot be edited. Only the "USER" mode can be customized.
2. The EQ mode will change to the 'USER' mode automatically when you change the values.

Specifications

General

Reference Supply Voltage	12V ==
Operating Voltage Range	10.5 - 15.8V ==
Max Operating Current.....	15A
Grounding System	Car Battery Negative Pole
Dimensions(WXHXD).....	178x100x75mm
Weight(main unit)	1.1kg

FM

Signal Noise Ratio	≥55dB
Residual Noise Sensitivity (S/N=30dB)	≤10dBμV
Frequency Response (±3dB)	40Hz-12KHz
Station Seeking Level.....	23±3dBμV
Distortion	≤1.0%
Stereo Separation (1KHz).....	≥25dB
Antenna Impedance.....	75Ω
Frequency range.....	87,5 /108,0MHz

DAB

Residual Noise Sensitivity (RF=72dBm).....	60dB
Stereo Separation (1KHz).....	≥55dB
Frequency range.....	174 /240MHz

AM

Residual Noise Sensitivity (S/N=20dB)	≤28dBμV
Selectivity (±9KHz)	≥50dB
Frequency range.....	522/1620KHz

BT

Frequency	2,402 - 2,480GHz
EIRP power	0.94dbm

LCD

Screen size.....	6.75 inches(16:9)
Display resolution.....	800x480dots
Contrast ratio.....	400
Brightness	280cd/m2

Power output

Frequency Response (±3dB)	50Hz-16KHz
Maximum Output Power	4×50W
Load Impedance	4Ω

AUX IN

Distortion	≤0.5%
Frequency Response (±3dB)	50Hz-20KHz
Audio Input Level	0.5Vrms

Audio

Audio Output Impedance.....	100Ω
Audio Output Level	2Vrms(Max)

Video

Normal Video Input Level (CVBS)	1.0±0.2V
Video Input Impedance.....	75Ω
Video Output Impedance	N/A
Video Output Level.....	N/A

Versione Software

MCU.....	Ver 01.00.2
----------	-------------

Connections

Power connector view

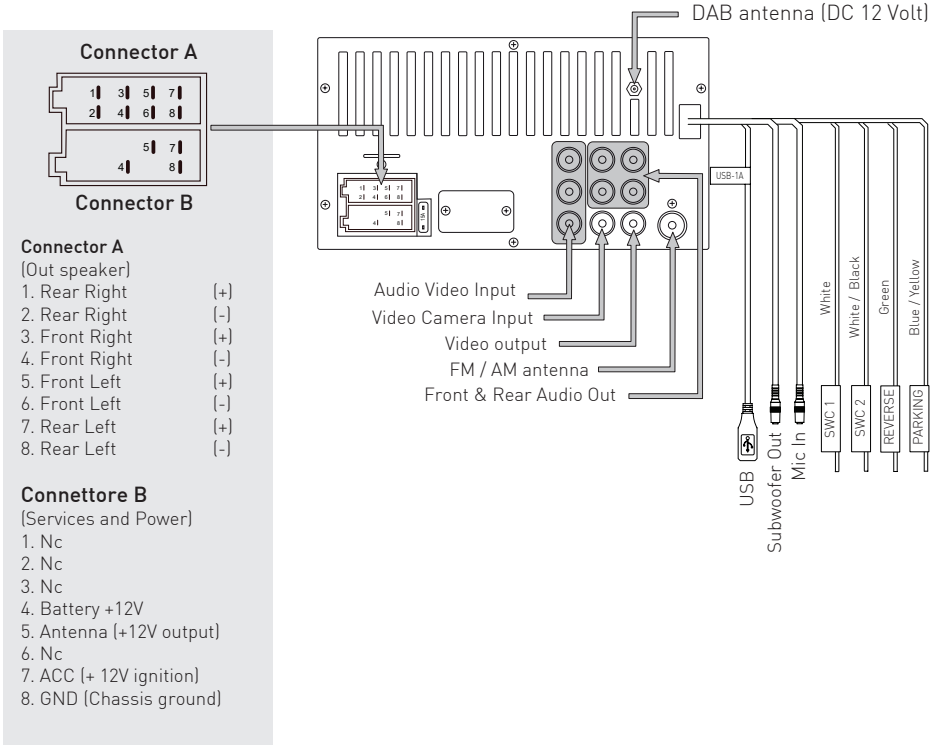

WARNING

DO NOT connect speaker wires to metal body or vehicle chassis.
 DO NOT connect the common (-) speaker cables to each other. Connect each speaker cable directly to each speaker terminal.
 All common (-) speaker cables must remain floating.

Before connecting the radio unit to the ISO connectors coming from the car, check the following conditions:

1. Make sure the pin assignments of the connector match with the macrom drive.
2. Pay attention to the power cord.
3. In case the battery lead and ignition lead do not match, change the position accordingly.
4. In case the car is not equipped with the ignition service, use a Macrom interface to obtain the missing service or services.

Dichiarazione di Conformità



The manufacturer GMA ITALIA s.r.l. declares that the type of radio equipment - Multimedia Receiver, model M-DL6800DAB, brand Macrom - complies with the 2014/53 / EU Directive.

The full text of the EU Declaration of conformity is available at the following internet address: www.macrom.it, or at GMA ITALIA s.r.l. - V. Di Vittorio, 7/33 Rho - 20017 (MI) Italy

Made in China by
GMA ITALIA s.r.l. - V. Di Vittorio, 7/33 Rho - 20017 (MI) Italy

Information on disposal of unit



This product bears the selective sorting symbol for waste electrical and electronic equipment (WEEE).

This means that this product must be handled to the local collecting points or given back to retailer when you buy a new product, in a ratio of one to one (or one to zero if the external dimension is less than 25 cm) pursuant to European Directive 2012/19/EC in order to be recycled or dismantled to minimize its impact on the environment.

For further information, please contact your local or regional authorities.

Electronic products not included in the selective sorting process are potentially dangerous for the environment and human health due to the presence of hazardous substances.

The unlawful disposal of the product carries a fine according to the legislation currently in force.

MACROM

w w w . m a c r o m . i t