

ANDROID MULTIMEDIA MONITOR

USER MANUAL

T1003DAB



DAB+
Digital Audio Broadcasting

MACROM

Contents

Safety Precautions	1-2
Warning.....	2
Product overview.....	3
Temporarily disconnecting the monitor.....	4
Monitor adjustment.....	5
Applications	6
Applications customization	6
System Setting.....	6
Video	7
General	8-9
Wallpaper.....	9
Wi-Fi.....	10
Bluetooth	10
Language	10
Volume Level	11
Navigation.....	11
Illumination key.....	11
SWC.....	11
Radio	12
DAB	13
Video.....	14
Music.....	15
Bluetooth	16
Apple Link Connection	17
Android Link Connection.....	18
Bluetooth	19
Music via Bluetooth.....	19
DSP (digital sound processor)	20-21
Connections overview.....	22
Specifications	23
Declaration of conformity	24

Safety Precautions

Thank you for purchasing this product. Please read through these operating instructions so you will know how to operate your model properly. After you've finished reading the instructions, keep this manual in a safe place for future reference.

Only connect the unit to a 12-volt power supply with negative grounding.

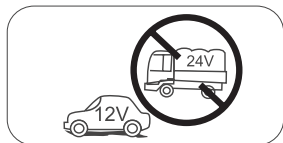

Never install this unit where the operation & condition for safe driving is impaired.

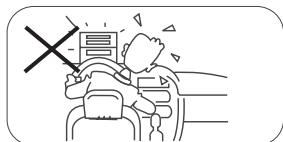

Never use the video display function in the front when driving to prevent the violation of laws & regulations and also to reduce the risk of traffic accident except for using rear view video camera.



Never expose this unit, amplifier, and speakers to moisture or water to prevent electric sparks or fire.

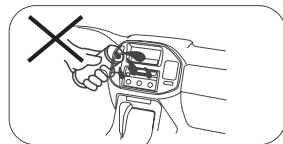

Please don't change the fuse on the power cord without professional guidance, using improper fuse may cause damage to this unit or even cause fire.

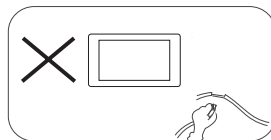

Please contact your nearest dealer if one of the following symptoms is experienced:

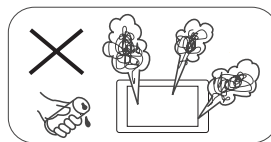

- (a). Water or other objects enters the unit.
- (b). There is smoke.
- (c). Peculiar smell.

To ensure safe driving, please adjust the volume to a safe and comfortable level in case of emergency situations.

Safety Precautions

1. Never disassemble or adjust the unit without any professional guidance.
For details, please consult any professional car shop / dealer for inquiry.
2. If the front panel or TFT monitor is dirty, please use a clean silicone cloth and neutral detergent to wipe off the spot. Using a rough cloth and non-neutral detergent such as alcohol for cleaning may result in scratching or decoloration to the monitor.
3. If any abnormal behavior of the unit is found, please refer to trouble shooting guide of this manual. If no relevant information is found, please press the [RESET] key on the front panel to resume factory default.
4. If you have parked the car in hot or cold weather for a long time, please wait until the temperature in the car becomes normal before operating the unit.
5. Using the car heater in low temperature environment may result in moisture inside the unit, DO NOT use the unit in this situation. Eject the disc and wipe off the moisture on the disc. If the unit still doesn't work after a few hours, please contact the service center.
6. Do not impact the LCD monitor which could cause damage.
7. To prevent damage to the screen, avoid touching it with sharp objects.
8. To provide a clear demonstration and an alternative for easy understanding to the operation of this unit, graphic illustrations are used.
However, some illustrations are different from the actual images displayed on the screen.
9. Operate the unit correctly according to this manual to prevent unnecessary problem. The guarantee won't be valid if the problem is caused by inappropriate operation.

Warning

Detect parking brake

- In order to be able to install the android application, the handbrake connection must be connected. Engage the parking brake for APP installation.
- Connect the cable "BRAKE" to the parking brake switch to view video files on the TFT monitor. Engage the parking brake for viewing videos.
- When the parking brake is not engaged, the monitor displays "Warning!!!, Video playback is disabled for your safety. Engage parking brake to watch video.", preventing the driver to watch content while driving. The rear screens are not interested in this inhibition.

Importante note:

This connection is indispensable for the proper operation.

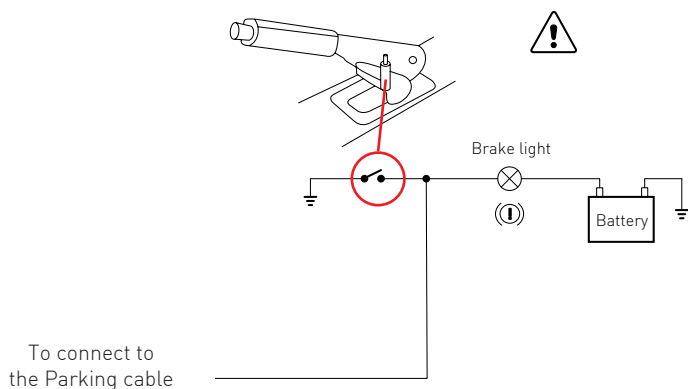

Product overview

Power the unit On/Off

When the unit is connected to the vehicle ignition system the device turns on and off autonomously, keys in the "ON" position radio on, keys in the "OFF" position radio off.

If you want to turn off the unit while keeping the vehicle On, press the volume knob for two seconds and to turn the radio device back on, hold down the volume again for 2 seconds.

Note:

if the radio has been turned off using the volume button, it is necessary to turn it back on using the volume button.



1. Music

Press the 🎵 icon to access the music function of the device.

2. Applications

Press the 🗄 icon to directly access the system applications.

3. Phone

Press the 📞 icon to access the Bluetooth function.

4. Navigation

Press the 📍 icon to start the function of the chosen navigation system.

5. Application Customization

Allows the 📱 icon to access the selection of favorite applications.

6. Home

Press the 🏠 icon to access the main page of the multimedia system.

7. Back

Press the ⬅ icon to return to the previous function.

8. Power/Volume / Mute

- POWER: Press and hold the 🔌 icon for two seconds to turn off the radio unit

- Volume: Rotate the knob to adjust the volume

- Mute: Short press 🔌 to activate Mute, press again to activate the audio.

9. Navigation

Press the 📍 icon to start the function of the chosen navigation system.

10. Telephone

Press the 📞 icon to access the Bluetooth function.

11. Reset

Press the reset button to reset the radio unit.

12. Applications

Main applications of the multimedia system. Note the applications are not editable by the user.

Temporarily disconnecting the monitor

Before inserting the radio unit into the frame and mounting brackets, disconnect the monitor by removing the plastic back-cover (figures 1 and 2).

Note: Do not insert the radio unit into the frame before removing the monitor.

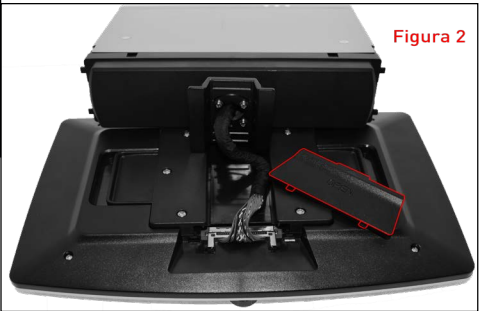
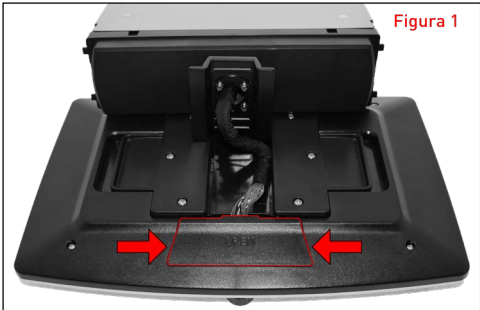

Next, while holding down the two side tabs, disconnect the flat connector that connects the monitor to the radio body (Figures 3 and 4).

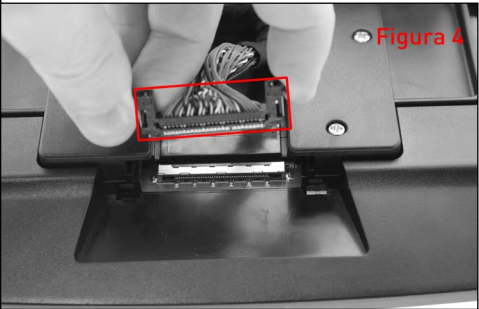
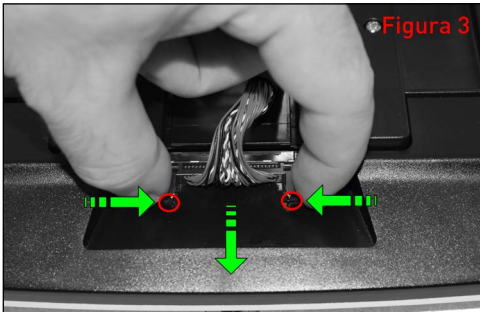

Monitor adjustment

In addition to the features included in the product, you can also adjust the tilt and vertical position of the monitor to suit your needs:



HORIZONTAL TILT - By firmly grasping the sides of the radio and applying slight pressure to the right or left side, you can tilt the monitor horizontally up to a maximum of 30° .



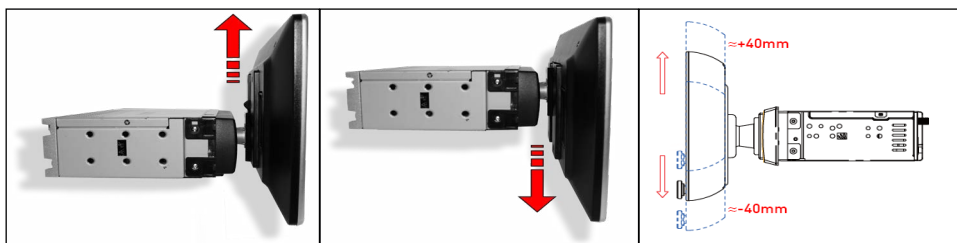

VERTICAL TILT - By firmly grasping the sides of the radio and applying slight pressure to the top or bottom, you can tilt the monitor up to a maximum of 30° .

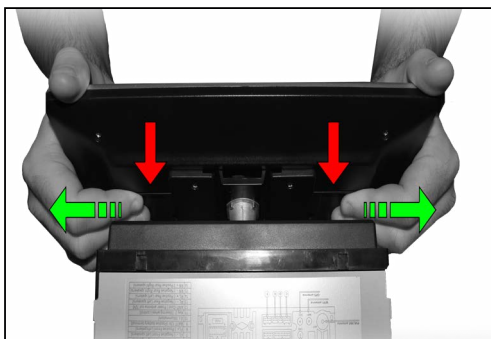

VERTICAL ADJUSTMENT - By firmly grasping the handles on the back of the monitor and pulling them outward, you can raise or lower the monitor up to a maximum of 40mm.



Applications

- 1. To access the applications of the multimedia device, press the [] icon on the screen.
- 2. Drag the screen from right to left and vice versa to view the pages of the next or previous applications.
- 3. Select the icon among those present to activate the desired function.
- 4. Press Back [] to exit and return to the main home page.

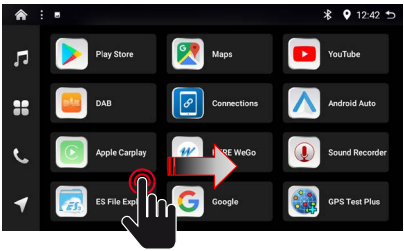
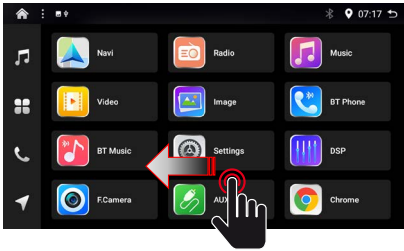

Application customization

The system allows you to customize the bar below the menu with 5 additional applications.

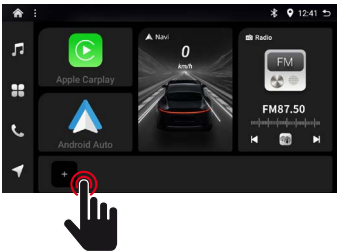

- 1. Press the  icon to access the selection of favorite applications.
- 2. Select the desired application(s) in sequence, a check mark next to the App shows the chosen selection.
- 3. Press OK to confirm the selection.
- 4. To delete or modify the selection, perform the process in reverse.

System setting



This "System Settings" section allows the user of the multimedia radio system to customize the multiple usage configurations of the device.

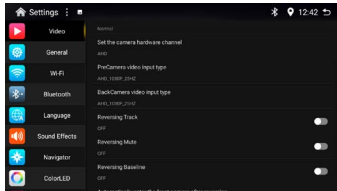

Video

 The following settings refer to the functions of the cameras connected to the device.

Driving Video		Motion video mode
On		Active
Off		Deactivate
Front Camera		Image display mode
Mirroring		Image inverted on the horizontal axis
Normal		Normal image view
Rear Camera		Modalità di visualizzazione della immagine
Mirroring		Image inverted on the horizontal axis
Normal		Normal image view
Set the camera hardware channel		Video input type
AHD		AHD high resolution signal
AVM		360 panoramic video signal (optional)
AUX-CVBS		Composite video signal
Front camera video input type		Front camera input video parameters
CVSB_NTSC		NTSC Composite Video
CVBS_PAL		PAL Composite Video
AHD_720_30Hz		High resolution video 720 dpi frequency 30Hz
AHD_720_25Hz		High resolution video 720 dpi frequency 25Hz
AHD_1080_30Hz		High resolution video 1080 dpi frequency 30Hz
AHD_1080_25Hz		High resolution video 1080 dpi frequency 25Hz
Rear camera video input type		Back camera input video parameters
CVSB_NTSC		NTSC Composite Video
CVBS_PAL		PAL Composite Video
AHD_720_30Hz		High resolution video 720 dpi frequency 30Hz
AHD_720_25Hz		High resolution video 720 dpi frequency 25Hz
AHD_1080_30Hz		High resolution video 1080 dpi frequency 30Hz
AHD_1080_25Hz		High resolution video 1080 dpi frequency 25Hz
TVI_720_30Hz		Transport video 720 dpi frequency 30Hz
TVI_720_25Hz		Transport video 720 dpi frequency 25Hz
TVI_1080_30Hz		Transport video 1080 dpi frequency 30Hz
TVI_1080_25Hz		Transport video 1080 dpi frequency 25Hz
Reversing Track		Parking maneuver area
On		Parking area visible
Off		Parking area excluded not visible
Reversing Mute		Mute source audio in Playback
On		Audio sorgente in playback disattiva (Mute)
Off		Audio sorgente in playback attiva (Play)
Parking Assistance Guideline		Parking Assistance Guidelines
On		Active guidelines
Off		Guidelines Off, Not Visible
Automatically enter the front camera after reversing		Auto front camera view mode
On		Front camera view automatically turns on
Off		Front camera view turns off
Delay to exit the front camera		
Do not close		Always active vision, manual exit via Back button
5 seconds		Active vision for 5 seconds automatic exit
10 seconds		Active vision for 10 seconds automatic exit
15 seconds		Active vision for 15 seconds automatic exit
20 seconds		Active vision for 20 seconds automatic exit
30 seconds		Active vision for 30 seconds automatic exit

General



General

The following settings refer to the general functions of the device.

AUDIO

Filter	If the files selected are smaller than xxx kb will not play
Without filter	
> 100kb	
> 300kb	
> 500kb	
> 800kb	
Buzzer	Audio beep when touching the screen
On	Active
Off	Disable (mute)
Link USB device, Auto Playback	Audio playback in automatic mode
On	Activate when USB device is inserted
Off	Requires opening of dedicated audio APP

RADIO

Radio area	Country radio tuner selector
USA	
China	
Japan	
Europe	Default setting
Arab	
OIRT	
Soud America 1	
Soud america 2	
Korea	
Australia	

PHONE LINK

Phone Link Application	Compatibility for device connectivity
NONE	None
AppleCarPlay	CarPlay only
Android Auto	Android Auto only
Apple CarPlay & Android Auto	All

NAVIGATION

Navigation Split screen	Split Screen Navigation and Audio Apps
On	Split screen active
Off	Split screen off
Navigation position when switching split screen	
Left side/top side	Left view mode
Right side/bottom side	Right view mode
Percentage on Navigation Mix (audio)	Navi Audio Mixing with Audio App
No Mix	No audio mixing
10	10% audio mix
↓	↓
50	50% audio mix
↓	↓
100	100% audio mix

General

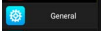

General

The following settings refer to the general functions of the device.

PARAMETRER

USB port 0 protocol		Determine USB protocol
USB2.0		Transfer speed 480mbts
USB1.0		Transfer speed 12mbts
USB 1-2 protocollo		
USB2.0		Transfer speed 480mbts
USB1.0		Transfer speed 12mbts

DISPLAY

Headlight Switch		Front key illumination
On		Always on with the device in Power On
Off		Ignition via car lighting service

USER INTREFACE

UI		User Interface Graphic Pattern
X5		Not editable by the user

Wallpaper



The T1003DAB device allows you to change the graphic wallpaper with a series of images pre-loaded in the product memory.

Select the page (Home) and press the icon to define the desired wallpaper.

Once you have finished choosing, press "Set wallpaper" to confirm the desired graphic.

1. Select the page () and press the icon to define the desired background.
2. Drag the bar from right to left and vice versa to view the available backgrounds
3. Select the desired background.
4. Confirm your choice by pressing [Sel wallpaper].

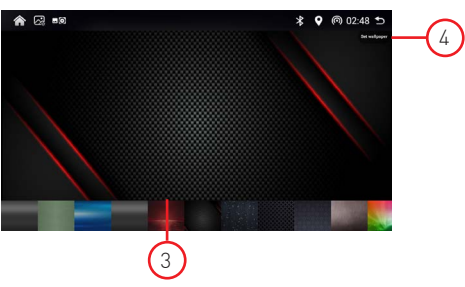
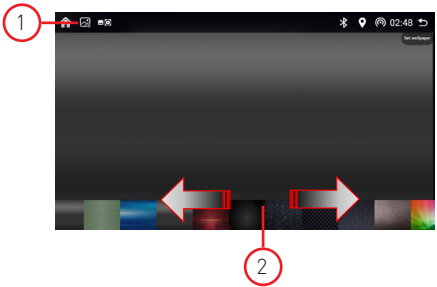

PIP



The T1003DAB device allows you to generate a picture in picture (PIP) so you can display Radio, DAB, Video and Music information overlaying the information generated by CarPlay and Android Auto.

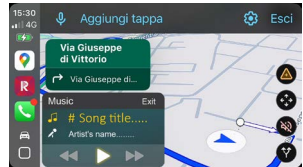

WiFi

Select "click to join" to get Wi-Fi, then select the desired access points and enter the password.

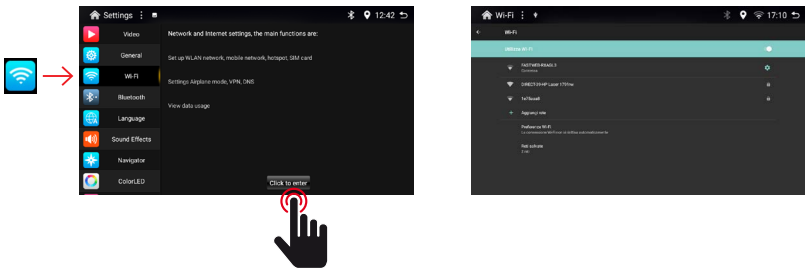

Bluetooth

Select "click to enter" to access the list of Bluetooth devices you want to pair with the device. Select the device to connect via BT, a pairing request will be displayed on the device to be paired, confirm the pairing and the screen shows the connection. The maximum pairing is two devices at the same time.

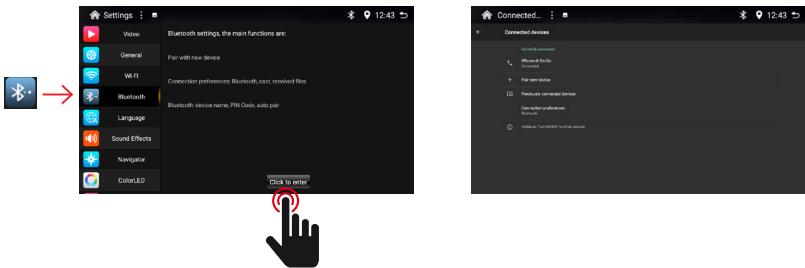

Language

Select the desired language to display the menu texts in your original language. In addition to the languages represented, you can add additional languages included in the system by pressing (+) More, "Add a language" selects the language to add to the remaining ones.



Volume Level

You can adjust the audio level of the various music sources between [0] and [+12] to optimize the balance between them.

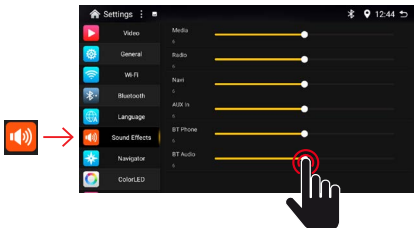

Media	[Audio from USB media]
Radio	[Audio from FM / DAB tuner]
Navi	[Audio from navigation system]
AUX In	[Audio from auxiliary input]
BT Phone	[Audio from BT conversation]
BT Audio	[Audio from BT streaming]

Navigation

You can determine the primary application of the navigation system.
Select only one application related to the navigation system from the application list.

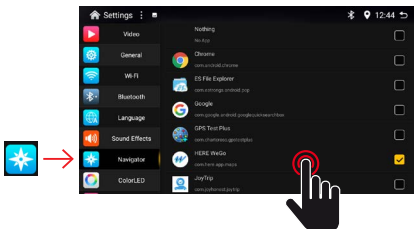

Illumination Key

Thanks to RGB lighting, you can customize the color of the front buttons of your multimedia device to your liking.

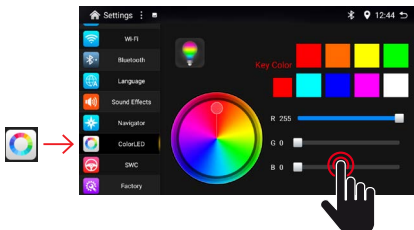

Eight colors of 100% intensity are available to you by pressing directly on the colored icons.

Alternatively, you can customize the coloring and its intensity using the three R. G. B. sliders.

SWC

The SWC [Steering Wheel Control] function allows you to learn the functions of the steering wheel controls of cars with resistive protocol.

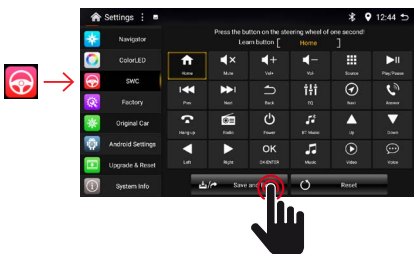

Proceed with an initial "backup" of the functions.

Select the first function you want to pair, for example (Home) and press the corresponding function on the steering wheel of the car.

Repeat the procedure for the other functions of the steering wheel.

When finished, press (Save) to confirm the process.

Radio



Tap the radio icon on the main interface to enter the radio mode.
You can also tap the radio icon on the application page.



1. **Station name**
If RDS data is available, you can display the station name.
2. **Station frequency**
The frequency of the tuned station.
3. **Radio text**
Radio text information transmitted by the tuned station
4. **Radio settings**
Options related to the RDS function
5. **Previous station search**
Use the arrow icon ◀ to search for the previous radio station.
6. **Frequency search keyboard**
Enter the frequency of the station you want to tune.
7. **Next station search**
Use the arrow icon ▶ to search for the next radio station.
8. **Loc/Distant**
Changes the reception sensitivity of the FM radio tuner
9. **Band Search**
Press Band to select FM1, FM2, FM3 and for AM1, AM2
10. **Audio Control**
⚙ DSP (access to the audio settings of the DSP "Digital Sound Processor")
11. **Radio Channel Presets**
Each band can store up to 6 radio channels.
The system can store 24 radio channels (18 FM channels and 6 AM channels).
12. **PIP**
🖼 Picture in Picture: this function allows you to activate a pop-up on the DAB screen so you can view content while navigating with CarPlay and Android Auto.
13. **Return (Back)**
Exit RDS radio settings.
14. **RDS**
RDS "Radio data system" (On/Off). Activates or deactivates the RDS function.
15. **AF**
Alternative Frequency (On/Off). Activates or deactivates the alternative frequency search.
16. **TA**
Traffic Announcement (On/Off). Activates or deactivates the search
17. **PTY**
Select the PTY list
18. **PI**
PI search (On/Off). Automatically activates the search for the corresponding station.

DAB



Tap the DAB icon on the main interface to enter DAB+ mode.
You can also tap the DAB icon on the application page.

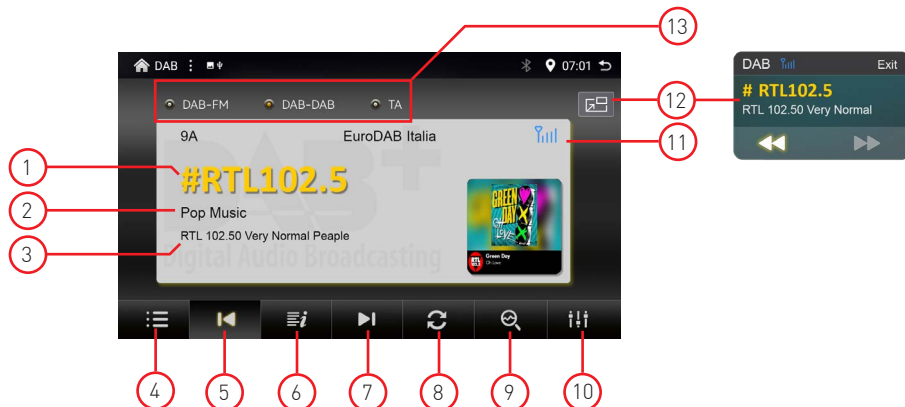

1. **Station name**
name of the received broadcaster.
2. **Program Type**
Type of program received.
3. **Radio text**
Radio text information transmitted by the tuned station
4. **Favorites list, Channel list, DAB Mux**
Search for stations by search type,
 - ★ Favorites (determined by the user by checking the star in the channel list)
 - Channel list (the complete list of channels received is shown after scanning)
 - Together (only stations contained in the MUX (Multiplex) package are shown)
5. **Search for previous stations**
Use the arrow icon ◀ to search for the previous DAB station.
6. **Search mode / Favorites / Channel list / DAB Mux**
Press sequentially to determine the search mode, Favorites, Channel list, DAB Mux.
7. **Search for next stations**
Use the arrow icon ▶ to search for the next DAB station.
8. **Channel update**
Allows you to update the previously performed scan.
9. **Channel scan**
Allows you to perform the initial scan and overwrite the previously performed one.
10. **Audio Control**
 - DSP (access to the audio settings of the DSP "Digital Sound Processor")
11. **DAB Signal**

The DAB signal indicator shows the level of the signal received in real time.

 - Excellent
 - Fair
 - Good
 - Low
 - Absent
12. **PIP**
Picture in Picture: this function allows you to activate a pop-up on the DAB screen so you can view content while navigating with CarPlay and Android Auto.
13. **Following Service**

DAB-FM: In the absence of a DAB signal, the tuner plays the sound of the same radio channel via the FM band.
Note: if the radio channel is not broadcast in FM, the tuner does not play any sound

DAB-DAB: In the case of driving between different areas, the tuner performs an alternative search in the DAB band.

TA: Traffic announcement. If present, the station transmits traffic information.

Video



Tap the Video icon on the main interface. The video files in the USB media will be played after selecting the desired track.



1. Video Folder

The main folder contains all the subfolders containing video files.

2. Previous

Press ◀◀ to go back to the previous video.

3. Play and Pause

Press ▶ to start playing or press to pause the video.

4. Next

Press ▶▶ to go to the next video.

5. Repeat All / Repeat 1 / Repeat Random

- 🔄 Repeat All (press to repeat the videos in the folder)
- 🔄 Repeat 1 (press to repeat the video currently playing)
- 🎲 Random (press to display an occasional video)

6. Video Settings

- 📺 Fit to Screen (fits the video to the screen size)
- 🖼️ Full Screen (fits the video size to full screen)
- 16:9 16:9 Screen (fits the video to 16:9 projection)
- 4:3 4:3 Screen (fits the video to 4:3 projection)

7. PIP

- 🖼️ Picture in Picture: this function allows you to activate a pop-up on the DAB screen so you can view content while navigating with CarPlay and Android Auto.

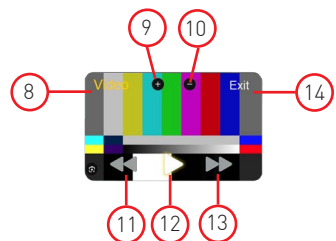

8. Video: press to return to the video function

9. ⏏ : press to enlarge the box (Zoom +)

10. ⏏ : press to reduce the box (Zoom -)

11. ◀◀ : press to return to the previous video track

12. ▶ : press to play or pause the video file

13. ▶▶ : press proceed to the next video track

14. Esc: press to exit and close the PIP

Music

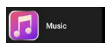

Tap the Music icon on the main interface. The music files in the USB media will be played after selecting the desired track.

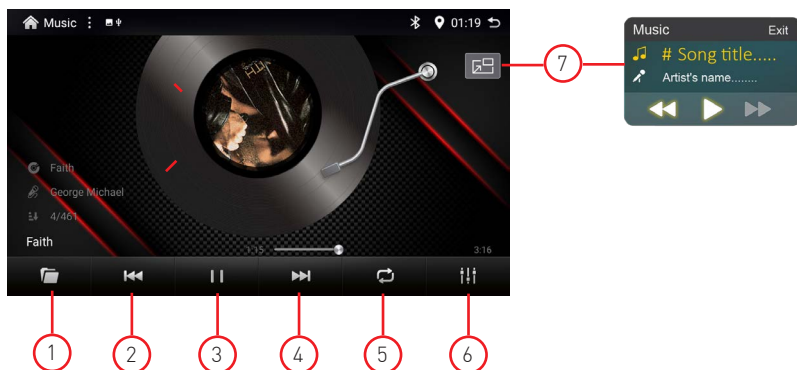

1. Audio Folder

The main folder contains all the subfolders containing music files.

2. Previous

Press ◀◀ to go back to the previous audio track.

3. Play and Pause

Press ▶ to start playback or press to pause the audio.

4. Next

Press ▶▶ to go to the next audio track.

5. Repeat All / Repeat 1 / Repeat Random

- 🔄 Repeat All (press to repeat the audio files in the folder)
- 🔄 Repeat 1 (press to repeat the audio file currently playing)
- 🎲 Random (press to play an occasional audio file)

6. Audio Control

- 🎚 DSP (access to the audio settings of the DSP "Digital Sound Processor")

7. PIP

- 🖼 Picture in Picture: this function allows you to activate a pop-up on the Music screen so you can view content while navigating with CarPlay and Android Auto.

Bluetooth



Bluetooth hands-free lets you make calls safely while driving.

Tap the Bluetooth icon to access Bluetooth settings.

1. Add Device

To activate the BT hands-free function, you need to pair your mobile phone with the unit.

- Activate the (Add Device) function to search for the phone you want to pair.
- Select the phone you want to pair from the list by pressing (Tap to pair).
- Confirm the pairing via the phone screen.



2. Keypad

After Bluetooth connection is established, the user can call directly on the phone or enter phone numbers on the keypad.

- A: Press to delete the incorrectly dialed number.
B: After dialing the phone number, press to make the call.
C: Press to close and abandon the call.

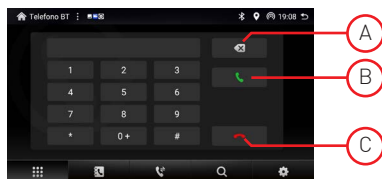

3. Phonebook

Contacts can be downloaded from your mobile phone to the unit via settings (6).

Press "Find Contacts" to search for a contact in the phonebook.

4. Call History

Call history shows outgoing call, incoming call and missed call.

5. Search

Phones connected with the device are shown.

Press (Add device) to pair a new device.

Press (-) to delete a paired device.

Press (Touch to pair) a new device.

Note: Connection can be made with two devices at the same time.

6. Settings

• Bluetooth

Device name T1003DAB to search on the phone.

Nota: All'occorrenza è possibile modificare il nome del dispositivo digitando sul nome del prodotto e definire il nuovo nominativo.

• Synchronize phonebook

Enable to pair your phone's phonebook.

• App calling through BT:

By activating the function in ON mode, the BT device allows you to converse with incoming calls via WeChat and WA applications.

Apple Link Connection

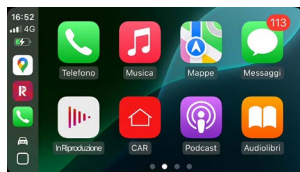

The Apple Link feature is the most advanced way to connect an iPhone to your multimedia system.

Access to smartphone functions such as calls, music, messaging, navigation and many other applications are available to you with Apple's voice assistance "Siri".

Device connection

To activate the Apple Link function, press the icon on the Home page and follow the "pop-up" messages that appear on the screen.

1. To start Apple Link, please pair your phone to Bluetooth by pressing [Pair].
2. Select the phone you want to connect to Bluetooth by pressing [Tap to pair].
3. A pairing request notification will be sent to the device to be paired.

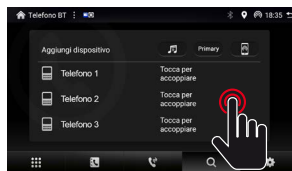

Confirm the pairing and then allow the use of the Carplay function.

Note: In wireless mode, a Wi-Fi connection may be required at the first connection. Activate the "Personal Hotspot" function on your Apple device and allow others to access.

Go to the settings of the T1003DAB device, activate WiFi and select the connection from the Apple device.

If prompted, enter the password you created for the temporary connection.

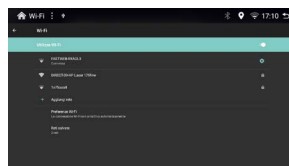

Phone Settings (Before you start)

1. Apple Link features may work differently than on your Apple iPhone.
2. Message and data charges may apply when using Apple Link.
Please check with your mobile carrier for usage charges.
3. Apple Link relies on the performance of the connected phone. If you experience performance issues:
 - Close all apps and restart them again.
 - Disconnect and reconnect your phone using the included Apple Lightning cable.

Apple uses Siri to perform many actions such as making calls, sending messages, searching for destinations, points of interest (POI) and many other functions.

Siri can be launched by pressing the Voice button on the screen or by using the steering wheel controls of the vehicle if the vehicle is equipped with a "Voice" button.

Voice commands are defined by Apple, please refer to the "Hey Siri" manual for the correct use of the applications.

NOTE: Make sure that the Siri voice function is activated in the ON position on your phone.

Consult your phone's manual to activate the feature.

Minimum requirements

- By original USB/Lightning data cable
- iPhone 5 or later
- iPhone with iOS 7.1 or later
- Mobile data plan

Your phone's CarPlay application may require content access permissions.

Consult your phone's manual to enable permissions.

Android Link Connection

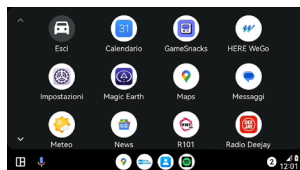

Android Link is a way to connect an Android device to your multimedia system.

Access to smartphone functions such as calls, music, messaging, navigation and many other applications are available to you with Google voice assistance.

Device connection

To activate the Android Link function, press the icon on the Home page and follow the "pop-up" messages that appear on the screen.

1. To start Android Link, please pair your phone with Bluetooth by pressing [Pairing].
2. Select the phone you want to connect to Bluetooth by pressing [Tap to pair].
3. A pairing request notification will be sent to the device to be paired.

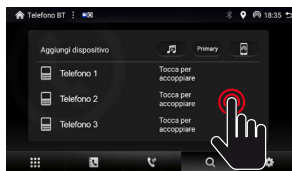

Confirm pairing and then allow the use of Android Auto.

Note: In wireless mode, a Wi-Fi connection may be required the first time you connect. Activate the "Personal Hotspot" function on your Android device and allow others to access.

Go into the T1003DAB device settings, activate WiFi and select the connection coming from the Android device.

If prompted, enter the password you created for the temporary connection.

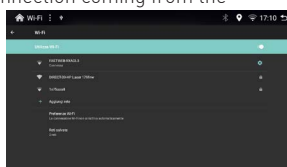

Phone Settings (Before you start)

1. Android Link features may work differently than on your Android device.
2. Message and data charges may apply when using Android Link. Please check with your mobile operator for usage charges.
3. Android Link relies on the performance of the connected phone. If you experience performance issues:
 - Close all apps and restart them again, or unplug and reconnect your phone.
 - It is recommended to use the original USB cable that came with your phone.

Android uses Google's voice recognition system to perform many actions such as making calls, sending messages, searching for destinations, points of interest (POI) and many other functions.

The voice function can be started by pressing the button  on the screen or via the car's steering wheel controls if the vehicle is equipped with a "Voice" button.

Voice commands are defined by Google, consult the "Ok Google" manual for the correct use of the applications.

NOTE: Make sure that Google Voice is set to ON in your phone.
Consult your phone's manual to enable the feature.

Minimum requirements

- Original USB data cable
- Compatible Android phone with OS 9.0 or later
- Active mobile data plan
- Wireless projection is compatible with Android 11.0 phone and 5GHz WiFi support.
- Android Auto must be available in your country or region

Your phone's Android Auto app may require content access permissions.
Consult your phone's manual to enable permissions.

Bluetooth

New connection



To connect a new mobile device, log in with the Connections app in the main menu.

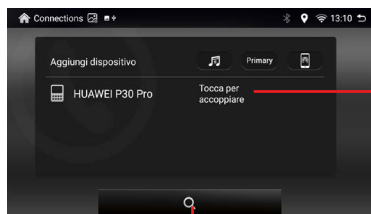

1. Press the lens to re-scan for devices.
2. Select the desired phone and press "Tap to pair"
Confirm the selection using your phone

Note:

To unpair a device, press [-] next to the name of the paired device.

Music via Bluetooth

A2DP Audio Streaming

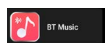

User can play music from mobile phone and transfer it to vehicle audio system via bluetooth.

NOTE: Due to Bluetooth compatibility, the connected device may not support all features or all phone models

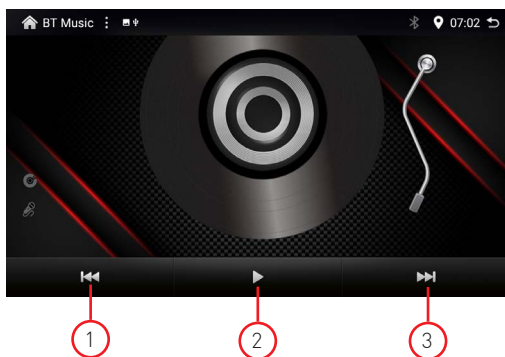

1. Previous

Press ◀◀ to go back to the previous audio track.

2. Play and pause

Press ▶ to start playback or press to pause the video.

3. Next

Press ▶▶ to go to the next audio track.

EQ (Equalizer)

The EQ function allows you to select the system's equalization curves or customize them to your liking using user presets.

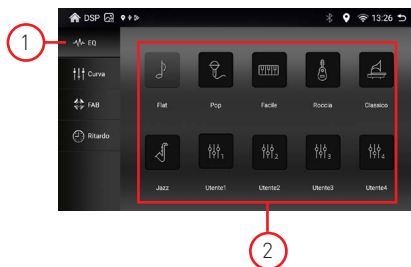

1. EQ
Press EQ to access presets.
2. Presets
Press the desired preset or customize the curve via User 1 to 4.

Curve

The function allows you to modify the equalization of the audio band in frequency, amplitude and width of the Q of intervention of the equalization curve.

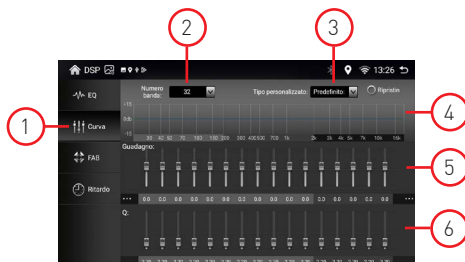

1. Curve
Press Curve to access the presets.
2. Number of bands
You can determine the number of bands from 3 - 16 - 32 - 48 - 64
3. Custom type
Allows you to select the Custom preset between 1st and 4.

4. Response Curve

Allows you to view in real time the changes to the audio settings defined via the equalization sliders.

5. Gain

Allows you to change the gain level between -8 and +8 dB for each previously predefined band.

6. Q (Quality factor)

It is possible to determine the width of the audio camber intervention for each single band between 0.40 and 16.30.

The lower the Q value, (0.40)
the greater the amplitude of the audio camber.

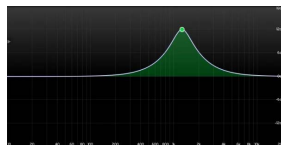

The higher the Q value, (16.30)
the less the amplitude of the audio camber.

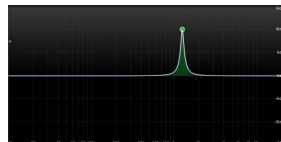

FAB

The FAB function allows you to change the listening point between front, rear, right and left, activate the subwoofer and sound compensation.

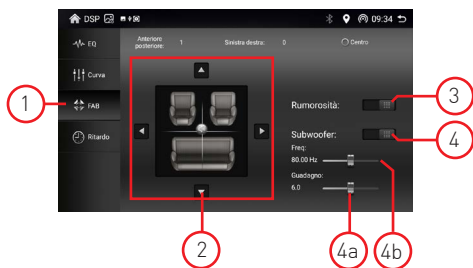

1. FAB
Press to access the system audio settings.
2. FAB
Using the cursors ▲, ▼, ►, ◀ you can determine the audio level of the various Front, Rear, Right and Left channels.
3. Loudness
Press to obtain a sound compensation

4. Subwoofer

Press to activate the subwoofer functions:

- The output audio level is adjustable from 0dB to +12dB.
- The low pass cut-off frequency is adjustable from 25Hz to 250Hz.

Delay

The function allows you to change the time alignment (sound delay) for each individual channel. Use the front-rear spacing adjustment of individual speakers so that the audio output is simultaneous.

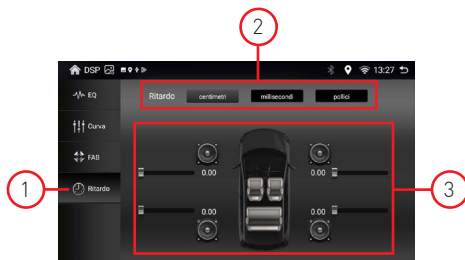

1. Delay
Press Delay to access the timeline settings.
2. Units of measurement
You can determine the desired unit of measurement for the timeline settings.
 - Centimeters:
adjustment between 0 and 340 centimeters
 - Milliseconds:
adjustment between 0 and 10 milliseconds
 - Inches:
adjustment between 0 and 133.86 inches

3. Cursors

Select the speaker(s) to which you want to apply the time alignment.

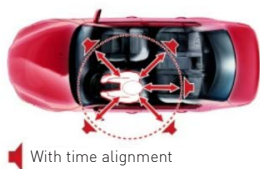

Connection Overview

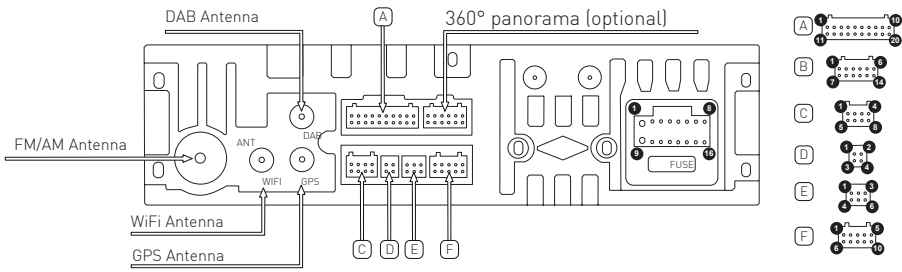

POWER CONNECTOR			
1	GND (Ground Chassis)	9	BATT 12V (Positive battery terminal)
2	Acc (Junction +12V)	10	ILL (Illumination)
3	Reverse	11	Key 2 (Steering wheel control)
4	Key 1 (Steering wheel control)	12	ANT-Cont (Power antenna out 12V)
5	FR - (Negative Front Right speakers)	13	RL - (Negative Rear Left speakers)
6	FR + (Positive Front Right speakers)	14	RL + (Positive Rear Left speakers)
7	FL - (Negative Front Left speakers)	15	RR - (Negative Rear Right speakers)
8	FL+ (Positive Front Leftspekers)	16	RR + (Positive Rear Right speakers)

A CONNECTOR			
1	AMP (+12V output amplifier power on)	11	GND - (Negative)
2	AUX-R (Right Audio Input)	12	RCA-FL (Front left audio output)
3	AUX-L (Left Audio Input)	13	RCA-FR (Front Right audio output)
4	SIM (Not available)	14	GND - (Negative)
5	SIM (Not available)	15	GND - (Negative)
6	SIM (Not available)	16	GND - (Negative)
7	SIM (Not available)	17	NC (Not available)
8	SIM (Not available)	18	SUB (Subwoofer audio output)
9	F-CAM (Front camera video input)	19	AUX-V (Auxiliary video input)
10	MIC - (Microphone negative input)	20	MIC + (Positive microphone input)

C CONNECTOR			
1	GND - (Negative)	5	NC (Not available)
2	RCA-RR (Rear right audio output)	6	RCA-RL (Rear left audio output)
3	SPDIF	7	GND - (Negative)
4	CAN-TX	8	CAN-RX

D CONNECTOR			
1	USB (1) +5 V	3	USB-DP1 (Positive data)
2	GND - (Negative)	4	USB-DN1 (Negative data)

E CONNECTOR			
1	USB (2) +5 V	4	OTGPP
2	GND - (Negativo)	5	OTGPP
3	USB-DP2 (Positive data)	6	USB-DN2 (Negative data)

F CONNECTOR			
1	TX	6	NC (Not available)
2	RX	7	GND - (Negative)
3	IR	8	CAM-IN (Rear camera video input)
4	P14	9	GND - (Negative)
5	Parking (Negative parking consent)	10	Antenna WiFi - BT

Specifications

General

Reference Supply Voltage	12V =
Operating Voltage Range	9 - 16V =
Max Operating Current.....	15A
Grounding system car battery negative pole	

FM

Signal Noise Ratio	≥55dB
Residual Noise Sensitivity (S/N=30dB)	≤10dBμV
Frequency Response (±3dB)	40Hz~12KHz
Station Seeking Level.....	23±3dBμV
Distortion	≤1.0%
Stereo Separation (1KHz)	≥25dB
Antenna Impedance.....	75Ω
Frequency range.....	87,5 / 108,0MHz

AM

Residual Noise Sensitivity (S/N=20dB)	≤28dBμV
Selectivity (±9KHz	≥50dB
Frequency range.....	522/1620KHz

DAB

Residual Noise Sensitivity (RF=72dBm).....	60dB
Stereo Separation (1KHz).....	≥55dB
Frequency range.....	174 / 240MHz

BT

Frequency	2,402 - 2,480GHz
EIRP power	5.44dbm

Power output

Frequency Response (±3dB)	50Hz~16KHz
Maximum Output Power	4×45W
Load Impedance	4Ω

AUX IN

Distortion	≤0.5%
Frequency Response (±3dB)	50Hz~20KHz
Audio Input Level.....	0.5Vrms

Audio

Audio Output Impedance.....	100Ω
Audio Output Level	2Vrms(Max)

Video

Normal Video Input Level (CVBS)	1.0±0.2V
Video Input Impedance.....	75Ω

Environment

Operating Temperature.....	-20°C ~ +70°C
Storing Temperature.....	-30°C ~ +80°C
Operating Humidity.....	45%~80%RH
Storing Humidity.....	30%~90%RH

Declaration of Conformity



The manufacturer GMA ITALIA s.r.l. declares that the type of radio equipment - Multimedia Monitor, model T1003DAB, brand Macrom - complies with the 2014/53 / EU Directive.

The full text of the EU Declaration of conformity is available at the following internet address: www.macrom.it, or at GMA ITALIA s.r.l. - Via G. Di Vittorio, 7/33 Rho - 20017 (MI) Italy

Made in China by
GMA ITALIA s.r.l. - Via G. Di Vittorio, 7/33 Rho - 20017 (MI) Italy

Information on disposal of unit



This product bears the selective sorting symbol for waste electrical and electronic equipment (WEEE).

This means that this product must be handled to the local collecting points or given back to retailer when you buy a new product, in a ratio of one to one (or one to zero if the external dimension is less than 25 cm) pursuant to European Directive 2012/19/EC in order to be recycled or dismantled to minimize its impact on the environment.

For further information, please contact your local or regional authorities.

Electronic products not included in the selective sorting process are potentially dangerous for the environment and human health due to the presence of hazardous substances.

The unlawful disposal of the product carries a fine according to the legislation currently in force.



w w w . m a c r o m . i t