

MONITOR

USER MANUAL

SM7001A 7-inch standalone monitor



MACROM

Product overview

Front view



Warning:

The images in this manual are for illustrative purposes only and may differ from the actual product. Please refer to the actual device unit.

1. Power button (On/Off)
2. Previous button
3. Next button
4. Channel selector button (CH1/CH2)
5. Menu button
6. SEL button / Image rotation

Remote control overview

1. Power button (On/Off)
2. Input channel selector (CH1 / CH2)
3. Next function selector.
4. Previous function selector.
5. The [Menu] button accesses the system settings:
 - Brightness - Contrast - Colour saturation - Language
 - Factory settings - V COM image quality
 - Guidelines On/Off (Only available on channel 2)
6. Image display selector

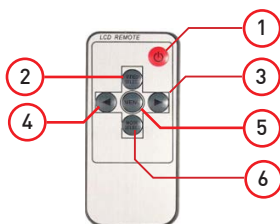

Connections

1. Positive +12V ACC
2. GNA (Negative)
3. Trigger

If a second CH1 video camera is present, it is possible to give viewing priority to the video camera connected to CH2 with the option of viewing guidelines.

Connect the green trigger wire to a +12V (e.g. reversing light).



Settings

MENU

Select the Menu icon to access the monitor settings.

PIN

The **PIC** icon gives you access to the image settings:

- Brightness
- Contrast
- Colour saturation
- Hue

Use the < / > buttons to select the desired intensity.

To move to the next function, press the ∨ / ∧ buttons.

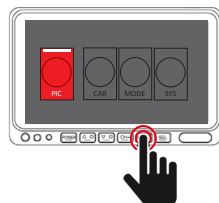

CAR

The CAR icon gives you access to the guidelines and rear camera delay settings.

Select ON to activate and OFF to deactivate the guidelines.

Select the rear camera delay between OFF:

- immediate deactivation by removing the Reverse service, or
- 2 seconds / 5 seconds / 10 seconds delay when switching off.

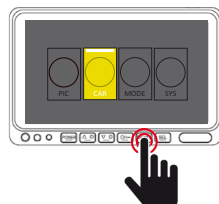

MODE

The MODE icon allows you to access the screen settings:

- Image rotation: 0 / 90 / 180 / 270°
- Image zoom: 4.3 or 16:9
- Auto Dim, automatic brightness dimmer

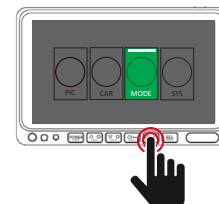

SYS

The SYS icon gives you access to the system settings:

- System language
- Screen saver, screen shutdown setting between:

Off (no screen shutdown setting)

1 minute, 3 minutes, 5 minutes, delay before shutdown.

- Reset, restore settings
- Software version

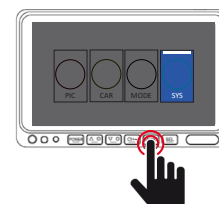

Installation

- Before completing the installation, temporarily connect the wiring and ensure that it functions correctly.
- Only use the parts included in the unit to ensure proper installation. Using parts not included in the package may cause malfunctions.
- This product must be installed by an authorised dealer in order to be covered by the warranty.
- Install the unit in a location that will not harm the driver or passenger in the event of a sudden stop, such as an emergency stop.
- Avoid installing the unit in locations subject to high temperatures, such as direct sunlight, hot air, or where it would be subject to dust or excessive vibration.
- Be sure to remove the front protective film after installing the unit.

Monitor Installation

Choose the monitor location in the vehicle so that it does not obstruct your view and complies with local laws for safe driving.

1. Dashboard
2. Mount

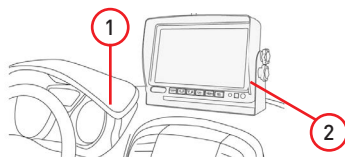

Specifications

Monitor

Size: 7-inch AHD IPS

Resolution: 1024xRGB*600 pixels

Contrast: 500:1

Power supply: DC12V-36V

System: PAL / NTSC (AUTO)

Video resolution: CVBS / 720P / 960P / 1080P HD 25/30fps

Input

Video channel 1: Auxiliary

Video channel 2: Rear camera

Parking guidelines: [Channel 2- On/Off]

Declaration of Conformity



The manufacturer G.M.A. Italia s.r.l declares that the **SM7001A** LCD monitor manufactured under the Macrom brand complies with Directive 2014/53/EU.

The full text of the EU Declaration of Conformity is available at the following Internet address:

www.macrom.it or at,

G.M.A.Italia s.r.l via G. Di Vittorio 7/33 - 20017 - Rho (MI) Italy.

Manufactured in China by

G.M.A.Italia s.r.l via G. Di Vittorio 7/33 - 20017 - Rho (MI) Italy.

Information for users of domestic appliances



Pursuant to Legislative Decree No. 49 of 14 March 2014 'Implementation of Directive 2012/19/EU on waste electrical and electronic equipment (WEEE)'.

The crossed-out wheeled bin symbol on the appliance indicates that the product must be collected separately from other waste at the end of its useful life.

The user must therefore take the intact equipment, with its essential components, to the appropriate separate collection centres for electronic and electrical waste at the end of its useful life, or return it to the retailer when purchasing new equipment of an equivalent type, on a one-to-one basis, or 1 to zero for equipment with a longest side of less than 25 cm. Proper separate collection for the subsequent recycling, treatment and environmentally compatible disposal of discarded equipment helps to avoid possible negative effects on the environment and health and promotes the recycling of the materials of which the equipment is composed.

Illegal disposal of the product by the user will result in the application of administrative penalties as per Legislative Decree No. 49 of 14 March 2014.

MACROM

w w w . m a c r o m . i t