

MULTIMEDIA MONITOR

USER MANUAL

DL903DAB



DAB+
Digital Audio Broadcasting



MACROM



Contents

General information	2
Package Contents	2
Safety instructions	3-4
Warning.....	4
Connection & Installation	5-6
Control Overview	7
Temporarily disconnecting the monitor.....	7
Monitor adjustment.....	8
Control elements.....	9
Setting	
General.....	10-11-12
Audio	13-14
Display	15
Bluetooth	16
Camera.....	17
Radio	18
About	19
Applications & functions	
Apple CarPlay	20
Android Auto	21
Handsfree	22
BT Audio.....	23
USB	23
Camera view	23
Radio AM/FM	24
Radio DAB	24
Aux input	24
Feature.....	25
Specifications	25
Declaration of Conformity.....	26
Information on disposal of unit.....	26

IMPORTANT NOTE:

Always follow the instructions in this manual before using the device. Keep this manual in the vehicle for future reference.

General information

Legal notice

- All registered product names, trade marks and brands are the property of their respective owners.
- This owner's manual was made with the utmost care.
- Technical changes and errors reserved.

Due to the ongoing development of this device, it is possible that the information in this manual is incomplete or is not matching to the delivery status.

Please visit periodically **www.macrom.it** on the internet, to check if additional information and updates are available.

Care and maintenance

This device is equipped with high precision and sensitive technique and should always be treated with caution. Please note the following tips to avoid endangering the warranty and extend the life of the appliance.

- Children under 12 should not operate the device. Keep the device and all accessories away from small children.
- Keep the device and its components dry. The effects of water, liquid or moisture can cause damage to the vehicle, the device itself or injury.
- Keep the device and its components away from excessive heat. High temperatures may shorten the life of appliance of the electrical components.
- Keep the device and its components away from excessive cold. Extreme temperature changes and moisture inside the device may cause the breaking of certain components. Do not drop the device and avoid violent shocks or excessive shaking.
- Do not use strong chemical cleaners, solvents or water to clean the device. Use a slightly moistened cotton cloth.
- Replace a blown fuse only with a new one with the same values. However, before replacing a defective fuse, first check what the cause of the short circuits. Start with the power cable. If the fuse blows again, there is a malfunction in the device. In this case, you should contact your authorized dealer.

Package Contents

- 1 x Main device with removable display
- 1 x 1-DIN metal installation frame including screw set and mounting rail
- 2 x Metal bracket
- 2 x Unlocking tool
- 1 x 20-pin system plug with ISO connection
- 1 x 16-pin ISO double connector with open cable ends
- 1 x Analog steering wheel remote control adapter
- 1 x External microphone including holder
- 1 x DAB Antenna
- 1 x GPS antenna including adhesive pad
- 2 x User Manual (English, Italian)

Safety Precautions

Thank you for purchasing this product. Please read through these operating instructions so you will know how to operate your model properly. After you've finished reading the instructions, keep this manual in a safe place for future reference.

Only connect the unit to a 12-volt power supply with negative grounding.

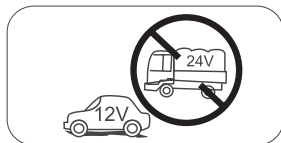

Never install this unit where the operation & condition for safe driving is impaired.

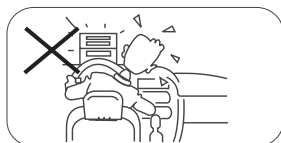

Never use the video display function in the front when driving to prevent the violation of laws & regulations and also to reduce the risk of traffic accident except for using rear view video camera.



Never expose this unit, amplifier, and speakers to moisture or water to prevent electric sparks or fire.

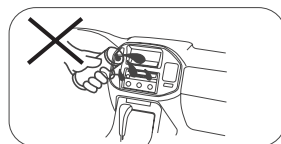

Please don't change the fuse on the power cord without professional guidance, using improper fuse may cause damage to this unit or even cause fire.

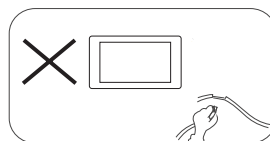

Please contact your nearest dealer if one of the following symptoms is experienced:

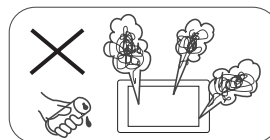

- (a). Water or other objects enters the unit.
- (b). There is smoke.
- (c). Peculiar smell.

To ensure safe driving, please adjust the volume to a safe and comfortable level in case of emergency situations.

Safety Precautions

1. Never disassemble or adjust the unit without any professional guidance.
For details, please consult any professional car shop / dealer for inquiry.
2. If the front panel or TFT monitor is dirty, please use a clean silicone cloth and neutral detergent to wipe off the spot. Using a rough cloth and non-neutral detergent such as alcohol for cleaning may result in scratching or decoloration to the monitor.
3. If any abnormal behavior of the unit is found, please refer to trouble shooting guide of this manual. If no relevant information is found, please press the [RESET] key on the front panel to resume factory default.
4. If you have parked the car in hot or cold weather for a long time, please wait until the temperature in the car becomes normal before operating the unit.
5. Using the car heater in low temperature environment may result in moisture inside the unit, DO NOT use the unit in this situation. Eject the disc and wipe off the moisture on the disc. If the unit still doesn't work after a few hours, please contact the service center.
6. Do not impact the LCD monitor which could cause damage.
7. To prevent damage to the screen, avoid touching it with sharp objects.
8. To provide a clear demonstration and an alternative for easy understanding to the operation of this unit, graphic illustrations are used.
However, some illustrations are different from the actual images displayed on the screen.
9. Operate the unit correctly according to this manual to prevent unnecessary problem. The guarantee won't be valid if the problem is caused by inappropriate operation.

Warning

Detect parking brake

- In order to be able to install the android application, the handbrake connection must be connected. Engage the parking brake for APP installation.
- Connect the cable "BRAKE" to the parking brake switch to view video files on the TFT monitor. Engage the parking brake for viewing videos.
- When the parking brake is not engaged, the monitor displays "Warning!!!, Video playback is disabled for your safety. Engage parking brake to watch video.", preventing the driver to watch content while driving. The rear screens are not interested in this inhibition.

⚠ IMPORTANT NOTE:

This connection is indispensable for the proper operation.

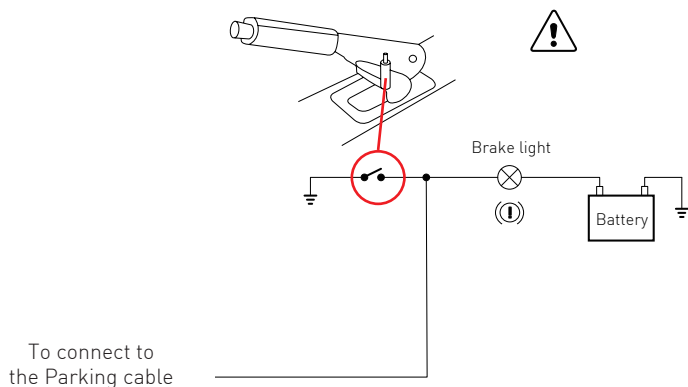

Connections & installation

DAB Antenna

Place the DAB antenna to the windshield and attach it there.

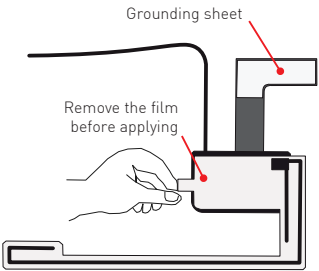
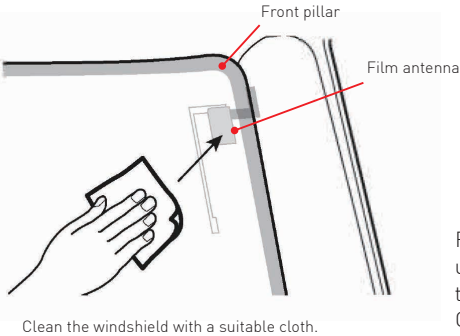

Remove the carrier sheet from the black amplifier unit and the foil antenna and stick the antenna onto the window.
Glue the copper-colored metal surface of the grounding blade to a bare metal part of the vehicle.

⚠ IMPORTANT NOTE:

In newer vehicles, the original vehicle antenna can usually be used for both analogue (FM/AM) and digital radio reception (DAB). If it does not have separate connections for FM/AM and DAB, a separately available antenna splitter must be used.

GPS Antenna

The GPS antenna should be glued horizontally to the dashboard with the adhesive side down. Reception is not possible with a metal-coated pane. Choose a level spot with a clear view of the sky.



External Microphone

The external microphone should be positioned in an easily accessible place, e.g. next to the sun visor or on the steering column.

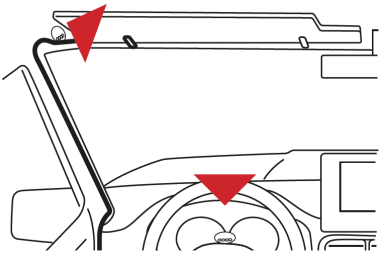

USB Port

Route the USB ports to the desired location, such as the glove box.

⚠ IMPORTANT NOTE:

Please note that the original USB sockets may not support CarPlay & Android Auto function.

Connections & installation

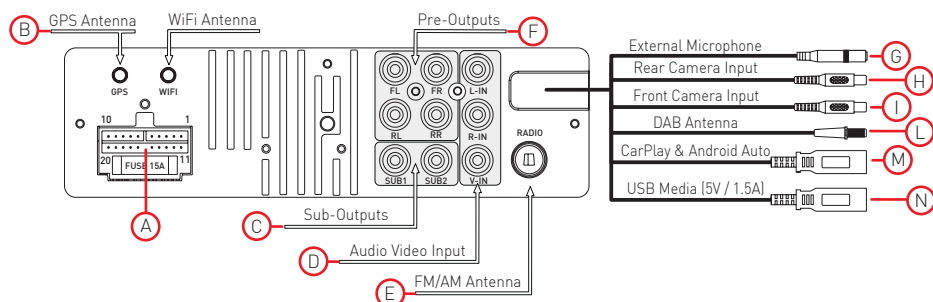

- (A)** Power connector included the steering wheel remote control.
 SWC Gnd (Black) Ground connection of the analog steering wheel remote control.
 SWC1(grey)Connection of the analog steering wheel remote control.
 SWC2 (red) Connection of the analog steering wheel remote control.
 You can then match the corresponding function keys on your analogue steering wheel remote control in the device.

Connector Pinout

- | | |
|---|--|
| 1 Rear Camera Power (+12V / 500mA MAX) | 11 Front Camera Power (+12V / 500mA MAX) |
| 2 Key 2 (Steering wheel control) | 12 Key 1 (Steering wheel control) |
| 3 RL - (Negative Rear Left speakers) | 13 ILL (Illumination +12V) |
| 4 RL + (Positive Rear Left speakers) | 14 ACC (Ignition +12V) |
| 5 FL - (Negative Front Left speakers) | 15 GND (Ground chassis) |
| 6 FL + (Positive Front Left speakers) | 16 BATT 12V (Positive battery terminal) |
| 7 FR - (Negative Front Right speakers) | 17 Reverse Input (+12V) |
| 8 FR+ (Positive Front Right speakers) | 18 Parking Brake Input (Negative) |
| 9 RR + (Positive Rear Right speakers) | 19 Antenna output (+12V / 500mA MAX) |
| 10 RR - (Negative Rear Right speakers) | 20 Remote Output (+12V / 500mA MAX) |

- (B)** GPS antenna (connect the GPS antenna so that CarPlay can work wirelessly)
- (C)** Subwoofer RCA line output
- (D)** Auxiliary Audio/Video Input
- (E)** Connection for vehicle's antenna plug (an adapter may be required)
- (F)** Pre-amplified outputs (Front & Rear 4 Volts)
- (G)** 3.5 mm jack for the included external microphone
- (H)** RCA connection for the input video signal of the rear camera
- (I)** RCA connection for the input video signal of the front camera
- (L)** Connection for the included DAB antenna
- (M)** USB port for Apple CarPlay, Android Auto and media with charging function 1.5A
- (N)** USB port for media with charging function 1.5A

Control overview

Function Buttons & Controls

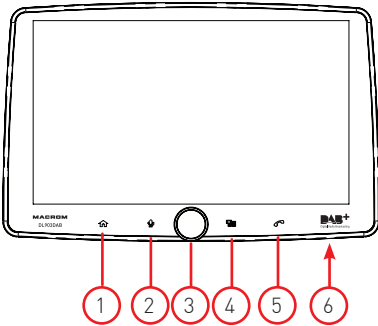

N.	Funzione	Descrizione
1	Home menu	Press short to go to the home menu.
2	Voice assistant	Press here to activate the voice assistant of your connected smartphone.
3	Volume	Turn the knob to adjust the volume.
	Mute	Press short to activate mute.
	Stand-by	Press and hold the button to switch the device to standby mode.
4	Source	Press here to switch between applications.
5	Phone	Press here to open the phone application or to answer an incoming call.
6	Reset	Press the button for more than 3 seconds and the system will restart without losing your settings.

Temporarily disconnecting the monitor

Before inserting the radio unit into the frame and mounting brackets, disconnect the monitor using the appropriate buttons on the front of the radio unit. It can be unhooked later if necessary, after first turning off the device.

Note: Do not insert the radio unit into the frame before removing the monitor.



Monitor adjustment

In addition to the features included in the product, you can also adjust the tilt and vertical position of the monitor to suit your needs:



HORIZONTAL TILT - By firmly grasping the sides of the radio and applying slight pressure to the right or left side, you can tilt the monitor horizontally up to a maximum of 25° .

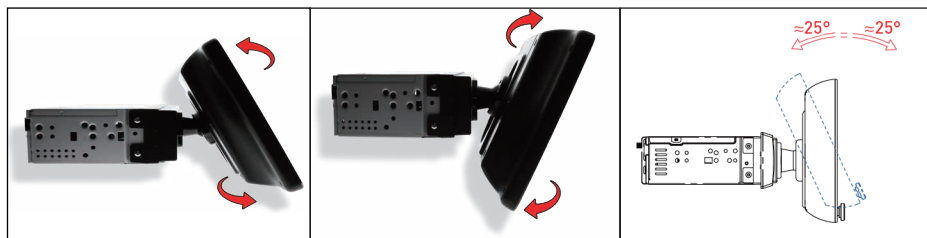

VERTICAL TILT - By firmly grasping the sides of the radio and applying slight pressure to the top or bottom, you can tilt the monitor up to a maximum of 30° .

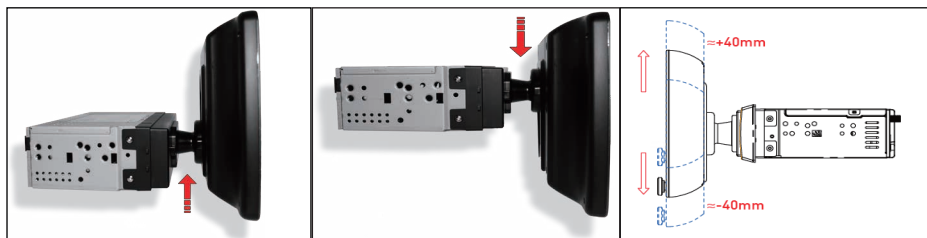

VERTICAL ADJUSTMENT - By firmly grasping the monitor, you can apply pressure to the top or bottom to raise or lower it up to a maximum of 40mm.







Control elements

Home Menu

This device has a very clear home menu, which you can operate by simply tapping the touchscreen. You can find more information about the individual applications and functions of the device starting from page 19.



At the top of the screen is the device's status bar. The information and symbols shown there have the following meaning:

Symbol	Function	Description
	Home menu	Tap it to go back to the Home menu.
	CarPlay or Android Auto	Tap it to open CarPlay or Android Auto if the device is connected to a smartphone.
	Time	Current time.
	Signal strenght	The current signal strength of the cellular connection of the smartphone connected to the device is displayed here.
	Battery level	The current battery level of the smartphone connected to the device is displayed here.
	Bluetooth	As soon as the device is connected to a smartphone via Bluetooth, this symbol will be displayed.
	GPS	This symbol only appears if the device has no or very weak GPS reception, which can occur in tunnels or in remote areas. The symbol disappears again as soon as a sufficiently strong GPS signal is received again. If the symbol continues to appear, the connection and function of the GPS antenna must be checked.

Settings "General"

General



Under **General** you can make various settings for the device.

Language

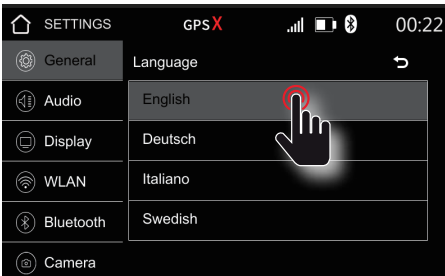

You can set the menu language under **Language**.

The available languages are:
Italian, English, German, French, Spanish.

To return to the home page, press back (↶).

Time Zone

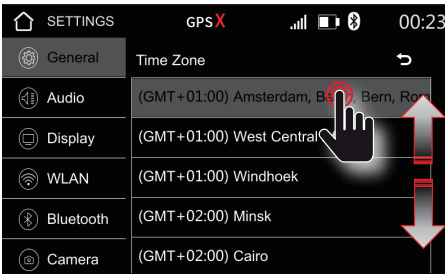

Under **Time Zone** you can set the desired time zone if you want to change the time zone automatically determined by GPS.

If necessary, drag the screen Up or Down to view more information about the time zone.

To return to the home page, press back (↶).

Date & Time

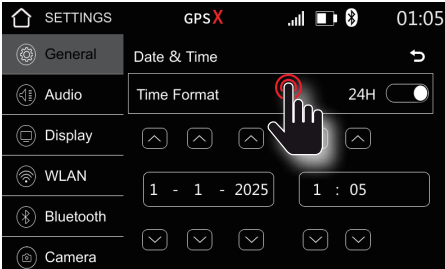

Under **Date & Time** you can set the desired time format (12H/24H) as well as the date and time manually if you want to change the time and date display determined by GPS.

To return to the home page, press back (↶).

Settings "General"

Daylight Saving Time



The slider next to **Daylight Saving Time** activates the daylight saving time display and the current time is advanced by 1 hour.

To return to the home page, press back (↩).

System Tone

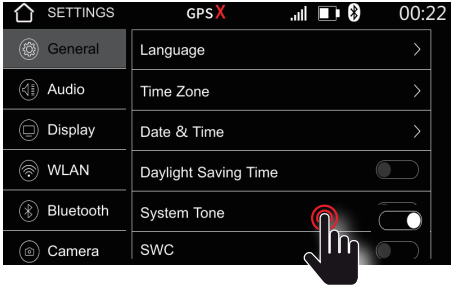

The slider next to **System Tone** activates the acoustic confirmation tone that sounds as soon as you tap one of the controls.

To return to the home page, press back (↩).

SWC

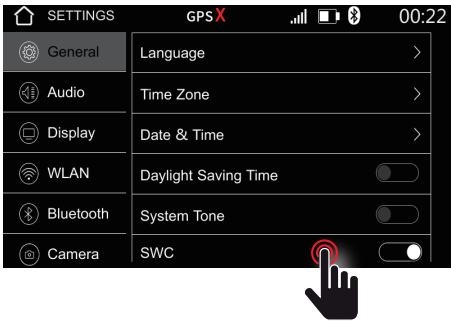

The slider next to **SWC** opens the steering wheel remote control learning menu.

By connecting the steering wheel remote to a vehicle with a resistive protocol, you can perform the learning process directly from the radio device.
In case you have the vehicle with Canbus protocol you must use a interface for communications between car and unit.

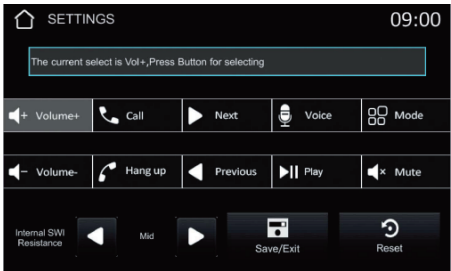

To pair, perform a function reset. Then press the first function you wish to pair (i.e., volume up) and press the corresponding button on the steering wheel.

Repeat this operation for all the functions available on the steering wheel.

Once all the functions have been assigned, press SAVE to exit the Menu.

Settings “General”

Power Off Delay

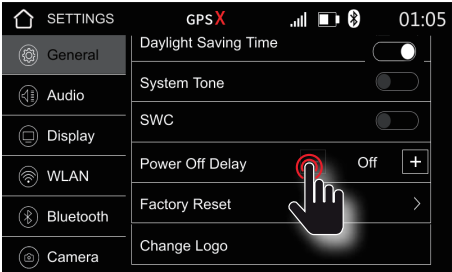

You can set a shutdown **Power Off Delay** between Off [0] and a maximum of three seconds. Use the +/- cursors to select the desired shutdown time.

To return to the home page, press back (⏮).

Factory Reset

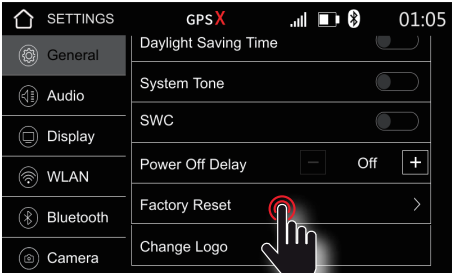

Under **Factory Reset** you can reset all settings of the device to the factory settings. Be careful, this will delete all your saved settings.

Press **OK** to confirm the restore operation.

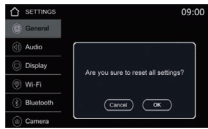

Change Logo

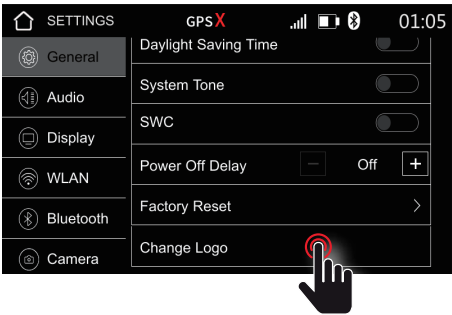

Under **Change logo** you can save your own boot logo. To do this, save a JPG with the file name **changelogo.jpg** in the root directory of the connected USB stick.

Press **Change** to confirm the new logo setting.

Settings “Audio”

Audio

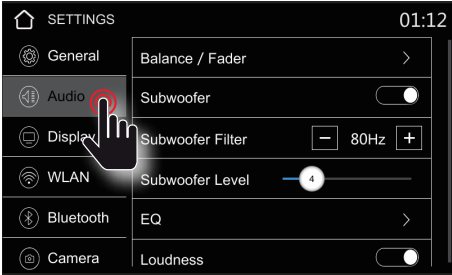

Under **Audio** you can make various audio settings.

Balance/Fader

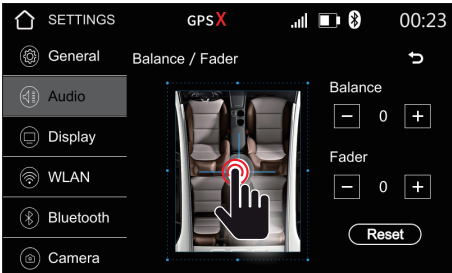

Under **Balance/Fader** you can adjust the balance of the acoustic stage between left and right and front and back.

To return to the home page, press back (↩).

Subwoofer

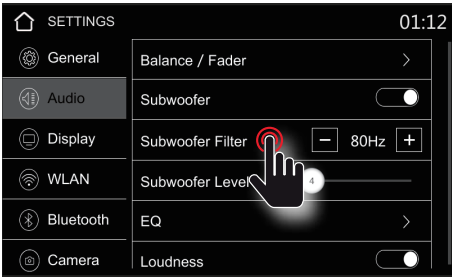

Subwoofer activates the SUB1/SUB2 pre-outputs. The cut-off frequency can be set under the Subwoofer Filter, i.e. all frequencies above are filtered out.

It is possible to change the subwoofer output level using the slider.

Equalizer (EQ)



In **EQ** mode you can manually adjust the 10 audio bands available to the equalizer from -6dB to +6dB or use the < / > buttons to select one of the presets:

Off (Flat), User, Jazz, HipHop, Pop, Rock, R&B.

Settings “Audio”

Loudness

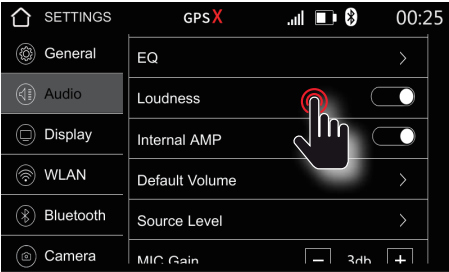

Loudness increases the highs and mids to make the sound louder and more powerful.

To return to the home page, press back (↶).

Internal Amplifier

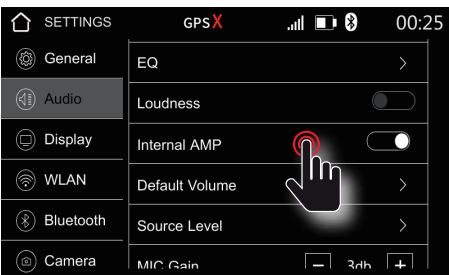

Under **Internal AMP** you can switch the device's integrated audio amplifier on or off. If you are using the device's preamp outputs to drive an external audio amplifier, turn off the amplifier.

Default Volume

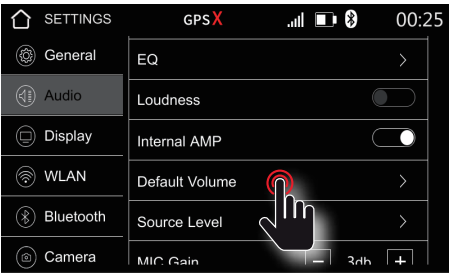

With **Default Volume** and **Source Level**, you can tune and adjust the levels for each application and signal source as desired.

To return to the home page, press back (↶).

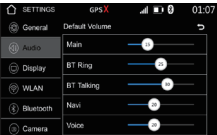

Microphone Level

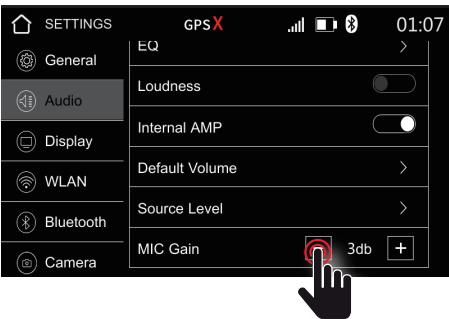

Under **Microphone Level** you can adjust the volume of the handsfree microphone with - / +.

The sensitivity of the external microphone can be changed between -9dB or +9dB depending on the position of the microphone in the vehicle.

Settings “Display”

Illumination Control

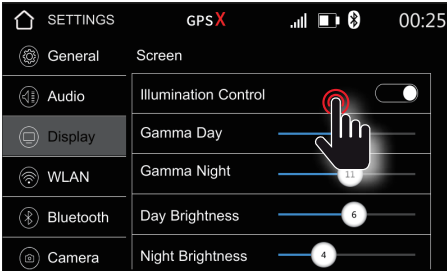

With **Illumination Control** you can activate the control function for the day and night light mode by the connected headlight trigger.

LED Animation

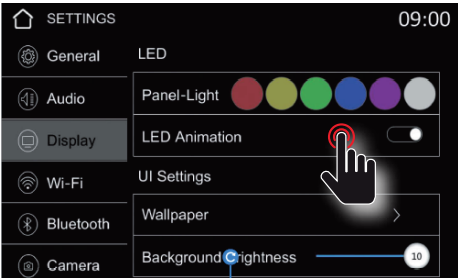

By disabling the **LED Animation** function, you can change the colors of the illumination of the front keys on the LCD panel.

Select the desired color from the six available colors.

UI Setting

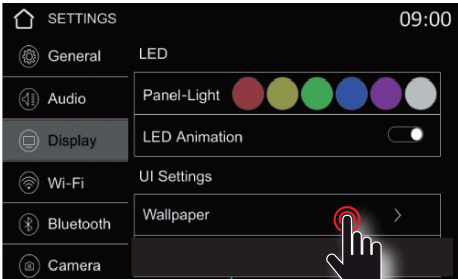

Under **UI Settings** you can set a different wallpaper color for the home menu.

Select the desired background color and press OK to confirm the selection.

Settings “WLAN”

WLAN (Wi-Fi)

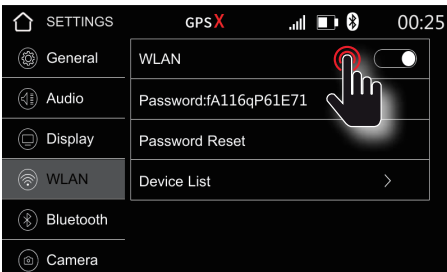

Under **WLAN** you can turn the Wi-Fi function on or off. This function is required for Apple CarPlay and Android Auto.

With **Password Reset** you can delete the device's password and reassign it.

Under **Device List** you can select a connectable smartphone that you would like to connect to the device. You can also delete devices that have already been registered there.

Settings “Bluetooth”

Bluetooth

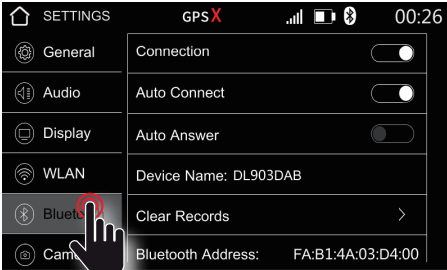

Under **Bluetooth**, you can connect your smartphone to the device for hands-free calling

This function is also required for Apple CarPlay and Android Auto.

Connection

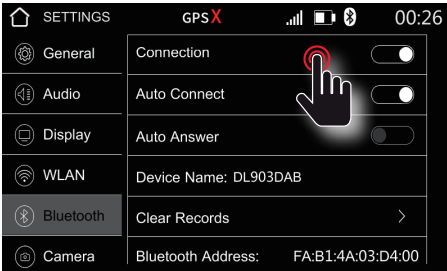

Using the Bluetooth **Connection** function, you can activate the phone's connection and answering functions.

Auto Connection

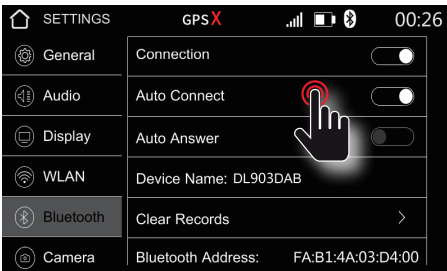

Under **Auto Connect** whether your smartphone should be automatically connected to the device after a restart.

Auto Connection

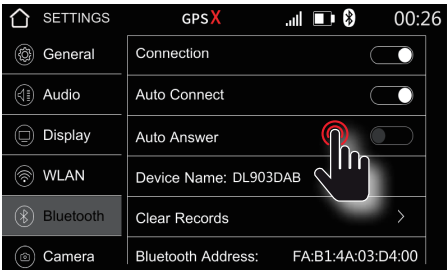

Under **Auto Answer** you can specify whether your smartphone should be whether calls should be answered automatically.

Under **Clear Records**, you can delete devices that have already been registered.

⚠ IMPORTANT NOTE:

- 1. To ensure a secure Bluetooth connection, you should be in a safe and non-public location.
- 2. Do not start the initial connection while driving, otherwise the driver could be distracted.

Settings “Camera”

Camera

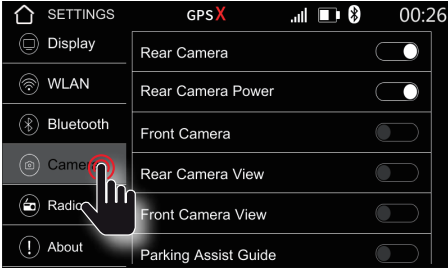

Under **Camera** you can make various settings for the connected cameras.

Rear Camera Power

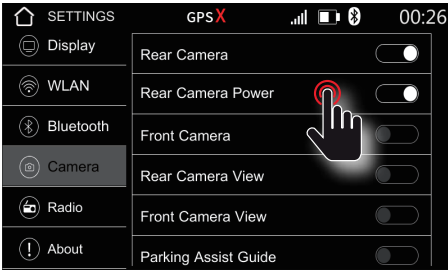

Here you can switch on the rear or front camera, switch on the respective power supply via the device and activate the respective view in the camera menu.

Parking Assist Guide

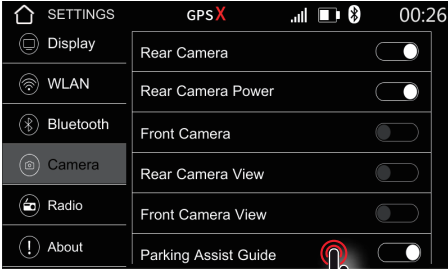

You can use the **Park Assist Guide** slider to turn on the rear view camera guidelines. With **Park Assist Guide Adjust** you can adjust the guidelines.

To return to the home page, press back (↶).



Rear Camera Delay

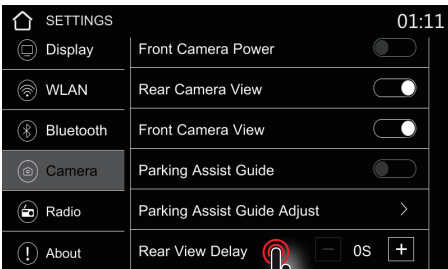

The **Rear Camera Delay** function increases the time it takes for the reverse gear vision. Settings range from 0 to 2 seconds.

Settings “Radio”

Radio

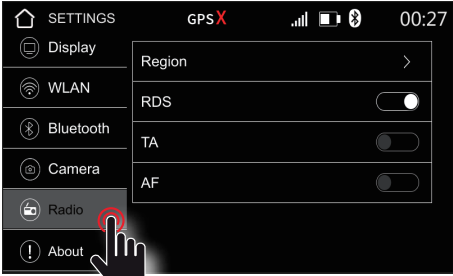

Under **Radio** you can set various settings for analogue radio reception.

Region & RDS (Radio Data System)

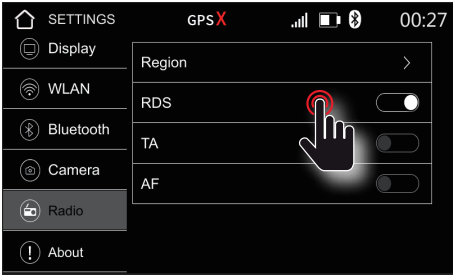

Under **Region** you can set the reception area.

With **RDS** function you activate the transmission of additional digital information such as station names or messages from FM radio stations.

To return to the home page, press back (↶).

TA (Traffic Announcement)

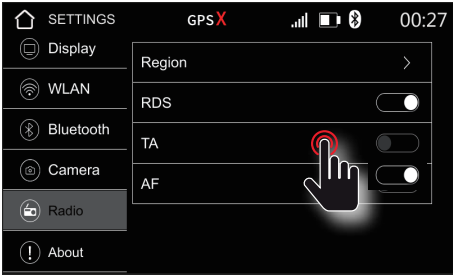

With **TA** function you allow traffic announcements from the most recently listened to FM station while playing other media.

AF (Alternative Frequencies)

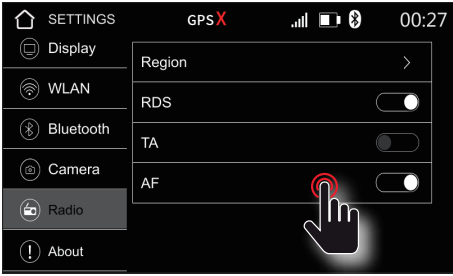

With **AF**, the radio switches to an alternative, better frequency of the station in the network if the reception signal is too weak and an alternative frequency is available.

Settings “About”

About

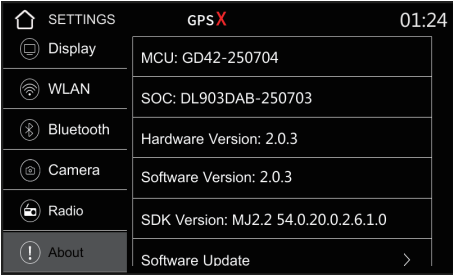

Under **About** you will find information about the software version of the device.

Software Update

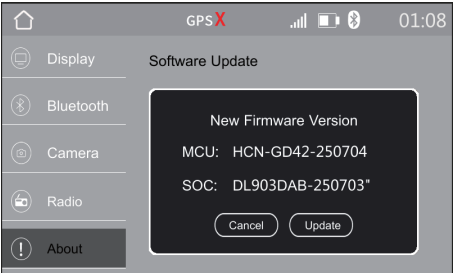

If updates are available you can update your system with the new firmware.

DO NOT USE FIRMWARE OTHER THAN THOSE PROVIDED BY THE MACROM MANUFACTURER.

Using different versions may compromise the correct functioning of the system

Applications & functions

Apple CarPlay

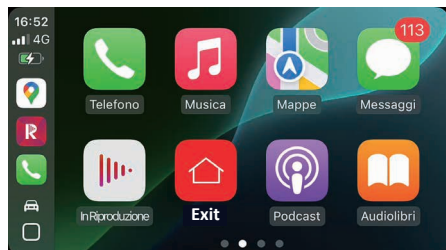

In order to use **Apple CarPlay**, you must first connect your iPhone to the device using a USB charging cable or Bluetooth.

Bluetooth and Wi-Fi must be activated on both devices. You may still need to activate the CarPlay function for this connection in your iPhone.

If you have enabled **Auto Connect** in the Bluetooth settings (see page 15), your iPhone will connect automatically every time until you delete the iPhone's registration or turn off CarPlay. To exit the CarPlay menu, tap **Exit**.

Phone Settings (Before you start)

1. Apple CarPlay features may work differently than on your Apple iPhone.
2. Message and data charges may apply when using Apple CarPlay. Please check with your mobile carrier for usage charges.
3. Apple CarPlay relies on the performance of the connected phone. If you experience performance issues:
 - Close all apps and restart them again.
 - Disconnect and reconnect your phone using the included Apple Lightning cable.

Apple uses Siri to perform many actions such as making calls, sending messages, searching for destinations, points of interest (POI) and many other functions.

Siri can be launched by pressing the Voice button on the screen or by using the steering wheel controls of the vehicle if the vehicle is equipped with a "Voice" button.

Voice commands are defined by Apple, please refer to the "Hey Siri" manual for the correct use of the applications.

NOTE: Make sure that the Siri voice function is activated in the ON position on your phone.

Consult your phone's manual to activate the feature.

Minimum requirements

- By original USB/Lightning data cable
- iPhone 5 or later
- iPhone with iOS 7.1 or later
- Mobile data plan

Your phone's CarPlay application may require content access permissions.

Consult your phone's manual to enable permissions.

⚠ IMPORTANT NOTE:

Please note that using some apps requires a mobile internet connection and may result in high data consumption.

Applications & functions

Android Auto

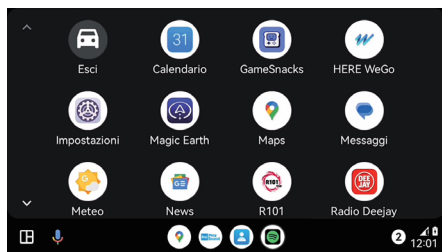

Android Link is a way to connect an Android device to your multimedia system.

Access to smartphone functions such as calls, music, messaging, navigation and many other applications are available to you with Google voice assistance.

Device connection

To activate the Android Link function, press the icon on the Home page and follow the "pop-up" messages that appear on the screen.

1. To start Android Link, please pair your phone with Bluetooth by pressing [Pairing].
2. Select the phone you want to connect to Bluetooth by pressing [Tap to pair].
3. A pairing request notification will be sent to the device to be paired.

Confirm pairing and then allow the use of Android Auto.

Note: In wireless mode, a Wi-Fi connection may be required the first time you connect. Activate the "Personal Hotspot" function on your Android device and allow others to access.

Go into the DL903DAB device settings, activate WiFi and select the connection coming from the Android device.

If prompted, enter the password you created for the temporary connection.

Phone Settings (Before you start)

1. Android Link features may work differently than on your Android device.
2. Message and data charges may apply when using Android Link.
Please check with your mobile operator for usage charges.
3. Android Link relies on the performance of the connected phone. If you experience performance issues:
 - Close all apps and restart them again, or unplug and reconnect your phone.
 - It is recommended to use the original USB cable that came with your phone.

Android uses Google's voice recognition system to perform many actions such as making calls, sending messages, searching for destinations, points of interest (POI) and many other functions.

The voice function can be started by pressing the button  on the screen or via the car's steering wheel controls if the vehicle is equipped with a "Voice" button.

Voice commands are defined by Google, consult the "Ok Google" manual for the correct use of the applications.

NOTE: Make sure that Google Voice is set to ON in your phone.

Consult your phone's manual to enable the feature.

Minimum requirements

- Original USB data cable.
- Compatible Android phone with OS 9.0 or later.
- Active mobile data plan.
- Wireless projection is compatible with Android 11.0 phone and 5GHz WiFi support.
- Android Auto must be available in your country or region.

Your phone's Android Auto app may require content access permissions.

Consult your phone's manual to enable permissions.

IMPORTANT NOTE:

Please note that using some apps requires a mobile internet connection and may result in high data consumption.

Applications & functions

Searching for Handsfree Device



To pair a new device in Bluetooth mode, press **Add New Device**, or search for the Macrom DL903DAB multimedia system via your phone's Bluetooth settings.

Once you have found the device you want to pair with, you will be asked to confirm a pairing code.

Press **OK** to proceed with pairing
To cancel the pairing, press the trash can.

Handsfree

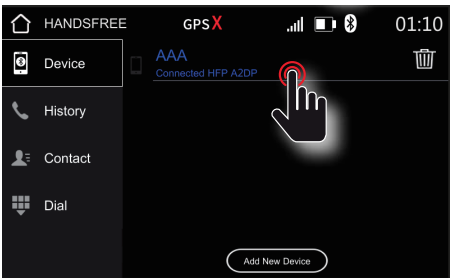

By tapping on **Handsfree** in the home menu you open the phone menu.

Select the mobile device you wish to use as Handsfree via the Device button

It is not possible to operate Apple CarPlay or Android Auto and the handsfree function at the same time. One of the two functions must be deactivated if necessary.

Chronology

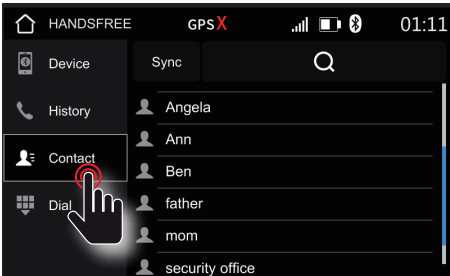



Once the device is connected to your phone, you can tap **History**, **Contact** and **Dial** on the left panel.

To download the address book, you need to synchronize your contacts using the **Sync** button.

If necessary, agree to download your contacts from your phone.

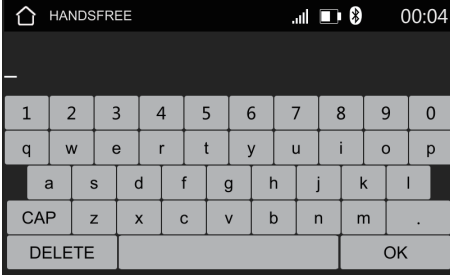
Contact Search



To perform an alphanumeric contact search, press the search lens .

Enter the contact's name and press OK to confirm. The contact list corresponding to the letter or number entered will be displayed.

⚠ IMPORTANT NOTE:

1. To ensure a secure Bluetooth connection, you should be in a safe and non-public location.
2. Do not start the initial connection while driving, otherwise the driver could be distracted.

Applications & functions

BT Audio

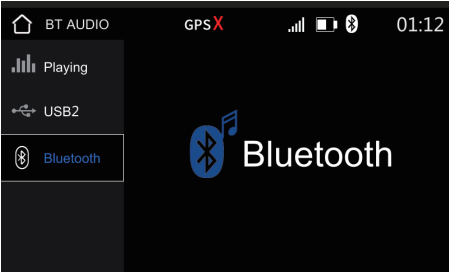

By tapping on **BT Audio** in the home menu, you open the Bluetooth audio streaming application. The controls and playback options of the audio player are located on the bottom control bar.

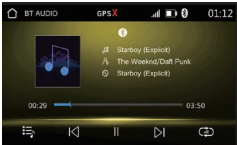

⚠ IMPORTANT NOTE:

If your cell phone is not yet connected to the device via Bluetooth, please follow the instructions on page 20.

USB

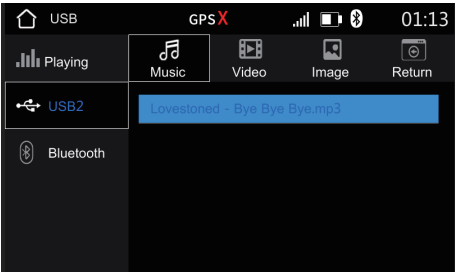

By tapping on **USB** in the home menu, you open the USB media player, which you can use to play compatible media such as music, videos and photos that are on a USB medium connected to the device.

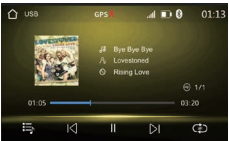

The controls and playback options of the media player are located on the bottom control bar. Compatible file formats: AVI, FLV, MOV, MKV, WMV, WMA, MP3, FLAC, JPEG, PNG, BMP

⚠ IMPORTANT NOTE:

Some cell phones require you to manually start your music player and manually select the playlist and tracks.

No videos or moving images may be played while driving, otherwise the driver could be distracted.

Camera view

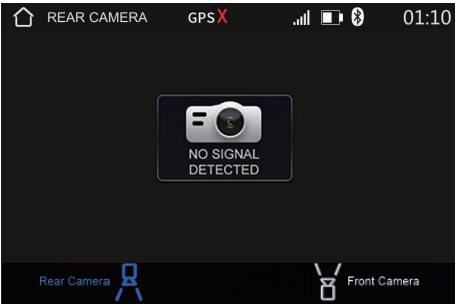

By tapping on **Camera** you open the camera display if you have connected a rear camera or a front camera to the device.

If you have two cameras connected, you can select the respective view on the control bar at the bottom.

Please note the information about the camera settings on page 15.

⚠ IMPORTANT NOTE:

If no camera is connected, this view will show **No Signal**.

Applications & functions

Radio AM/FM

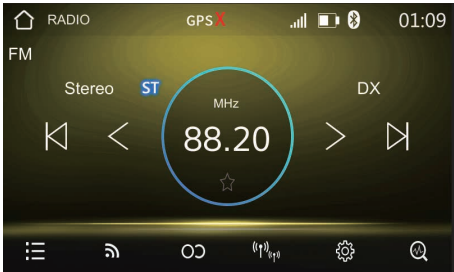

By tapping on **Radio** in the home menu you open the menu for analog radio reception. First, carry out a channel search, which you can start with the lens symbol . You can mark the current station as a favorite using the star symbol ★ below the frequency display. Below you will find further controls such as station list, FM/AM switching, stereo/mono switching, DX/ local switching and radio settings.

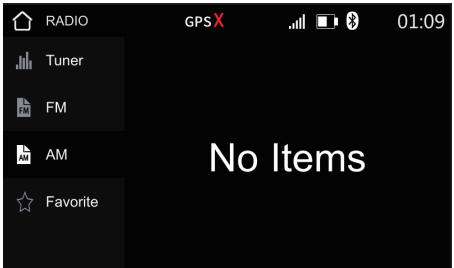

In the FM/AM section, select the stations you want as Favorites by marking them with a star. To delete the preset, remove the star you previously applied.

Stations previously selected as favourites will be displayed in the Favourites section.

Press Tuner to display the station in playback mode and to return to the radio source home page.

Radio DAB



By tapping on **DAB** in the home menu you achieve the digital radio reception. First, carry out a channel search, which you can start with the Auto Tune button.

You can save your desired channel as a favorite using the 18 preset buttons on the DAB home screen.

In the station list, select the desired station and then press and hold the preset button you want to use.

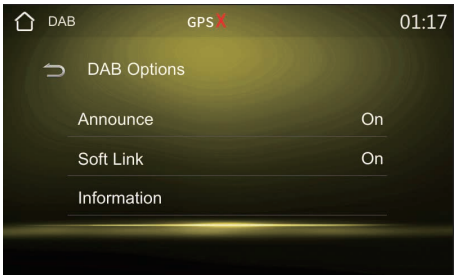

In the settings you will find the function to activate or deactivate the announcements, the Soft Link function to suppress the initial noises.

The playback channel information can be viewed using the Information button

AUX (Audio/Video Input)



By tapping on **AUX** in the home menu you open the view of the external playback device connected to the AUX inputs.

Features

- MULTIMEDIA MONITOR
- Universal 1 DIN body frame
- Detachable front panel
- 9" LED Capacitive display
- FM-RDS /AM tuner
- DAB+ built in with DAB antenna
- Works with CarPlay & Android Auto
- Compatible with wireless phones
- 2 USB slots input
- CarPlay & Android Auto
- Media Player /Charging (1.5A)
- Media player audio/video & photo
- 5.0 Bluetooth hands-free
- A2DP Bluetooth streaming
- GPS received for optimized position
- External microphone
- Multi language system
- Selectable RGB illumination
- Changeable wallpaper background
- Custom welcome logo
- 4 x 45 Watt internal amplifier
- DSP with 10 EQ bands
- Front & RearPre-output line (4 Volts)
- 2 Subwoofer pre-output line (4 volts)
- 1 Audio Video input
- Front & Rear camera input (CVBS)
- Large rotatable volume knob
- Built-in resistive programmable SWC

Specifiche

General

Reference Supply Voltage	12V \equiv
Operating Voltage Range	9 - 16V \equiv
Max Operating Current.....	15A
Grounding system car battery negative pole	

FM

Antenna Impedance.....	75 Ω
Frequency range.....	87,5 /108,0MHz

AM

Frequency range.....	522/1620KHz
----------------------	-------------

DAB

Frequency range.....	174 /240MHz
----------------------	-------------

BT

Frequency	2,402 - 2,480GHz
EIRP power	5.44dbm

WiFi

Frequency	2412 - 2484 MHz
EIRP power	12,0 dBm
Frequency	5180 - 5825 MHz
EIRP power	18,0 dBm

Power output

Maximum Output Power	4x45W
Load Impedance	4 Ω

AUX IN

Audio Input Level	1.0Vrms
-------------------------	---------

Audio

Audio Output Impedance.....	100 Ω
Audio Output Level	4Vrms(Max)

Video

Normal Video Input Level (CVBS)	1.0 \pm 0.2V
Video Input Impedance.....	75 Ω

Declaration of Conformity



The manufacturer GMA ITALIA s.r.l. declares that the type of radio equipment - Multimedia Monitor, model DL903DAB, brand Macrom - complies with the 2014/53 / EU Directive.

The full text of the EU Declaration of conformity is available at the following internet address: www.macrom.it, or at GMA ITALIA s.r.l. - Via G. Di Vittorio, 7/33 Rho - 20017 (MI) Italy

Made in China by
GMA ITALIA s.r.l. - Via G. Di Vittorio, 7/33 Rho - 20017 (MI) Italy

Information on disposal of unit



This product bears the selective sorting symbol for waste electrical and electronic equipment (WEEE).

This means that this product must be handled to the local collecting points or given back to retailer when you buy a new product, in a ratio of one to one (or one to zero if the external dimension is less than 25 cm) pursuant to European Directive 2012/19/EC in order to be recycled or dismantled to minimize its impact on the environment.

For further information, please contact your local or regional authorities.

Electronic products not included in the selective sorting process are potentially dangerous for the environment and human health due to the presence of hazardous substances.

The unlawful disposal of the product carries a fine according to the legislation currently in force.



w w w . m a c r o m . i t