

# REAR VIEW MIRROR

## USER MANUAL

**MM7002A** Rear view mirror with 7 inch AHD LCD monitor



# MACROM

# Connections

## Power supply

1. GND, connect the black wire to the car chassis negative.
2. Switching on the +12V Monitor, connect the red power supply cable to the car ACC key injection.
3. Reversing camera image activation, connect the green wire to the reverse light.

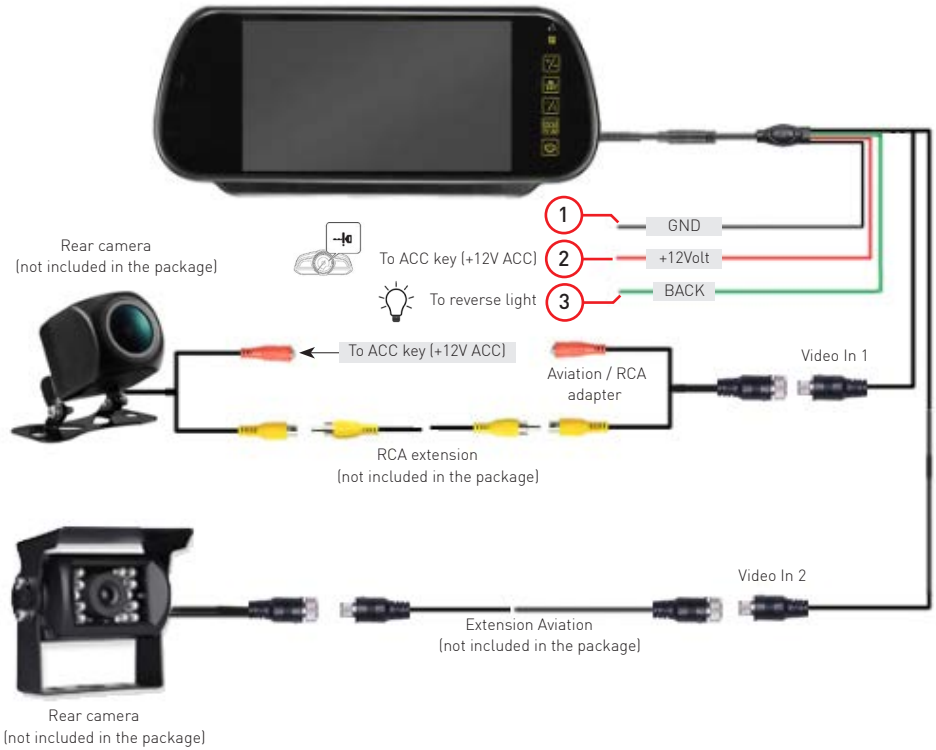

# Functions

## Product overview



1. Next function selector
2. Use the (Menu) key to access the system settings:
  - Brightness
  - Contrast
  - Color saturation
  - Language
  - Factory Default Settings
  - V COM image quality
  - Guidelines On/Off (Available on channel 2 only)
3. Previous function selector.
4. Input channel selector (CH1 / CH2)
5. On/Off power key

## Remote control overview

1. On / Off button (On/Off)
2. Input channel selector (CH1 / CH2)
3. Next function selector.
4. Previous function selector.
5. Use the (Menu) key to access the system settings:
  - Brightness
  - Contrast
  - Color saturation
  - Language
  - Factory Default Settings
  - V COM image quality
  - Guidelines On/Off (Available on channel 2 only)
6. Function not available

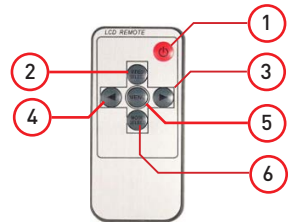

# Installation

---

## Placement

Place the monitor above the vehicle's original rear view mirror.  
Thanks to the extendable fixing flaps from 5.5 to 7.5 cm, it adapts to all shapes of vehicle rear-view mirrors.



## Specifications

---

### Monitor

- Size ..... 7 inch AHD IPS
- Resolution ..... 1024xRGB\*600 Pixel
- Contrast..... 500:1
- Power supply..... DC12V-36V
- Video system ..... PAL / NTSC (AUTO)
- Video resolution ..... CVBS / 720P / 960P / 1080P HD 25/30fps

### Inputs

- Video channel 1 .....Auxiliary
- Video channel 2 ..... Rear view camera
  
- Parking Guideline .....(Channel 2- On/Off)

