



## M-SW250A 800W PEAK POWER



10-inch subwoofer in reflex box with integrated 350 W RMS amplifier

When the desire for bass is great, but you don't want to sacrifice your trunk, the solution is the M-SW250A amplified subwoofer.

With a height of only 7.8cm, an ULTRA-FLAT cabinet in "Reflex" configuration, 10 inch speaker and an integrated class D amplifier, can be easily placed in the trunk of the vehicle.



The 350W RMS Class D amplifier, housed in the bottom of the cabinet, boosts deep, precise bass through easy access to the high-level or line (RCA) inputs with auto-sensing function.

With the external remote control, you can change the subwoofer's audio output level in real time, adjust the frequency cutoff, change the Bass Boost and rotate the phase if necessary.





## M-SW250A 800W PEAK POWER



10-inch subwoofer in reflex box with integrated 350 W RMS amplifier



### Features

- Class D power amplifier
- Output power 350W RMS
- Frequency cut-off from 30 to 150HZ
- Input sensitivity
  - RCA from 100mV to 2V
  - High level greater than 2V
- Phase rotation 0/180°
- Bass Boost adjustable from 0 to 3 dB
- Signal to noise ratio > 80dB
- Automatic On/Off power on
- Supply voltage 9 / 15.5V
- Maximum absorption 35°
- Dimensions 350 x 602 x H 78mm
- EAN: 8053839214973
- Master box
  - Unit: 1 piece
  - Gross weight: 7.6 Kg
  - Volume: 0.048 MC



M-SW250A 800W PEAK POWER



□ Product overview





## M-SW250A 800W PEAK POWER



### Amplifier

Equipped with remote control for precise and easy sound adjustment: input sensitivity adjustable between 100mV and 2 volts, frequency cut adjustment from 30 to 150Hz, Bass Boost to emphasize low frequencies, phase control 0 / 180°, make the device an indispensable complement to the vehicle audio system.

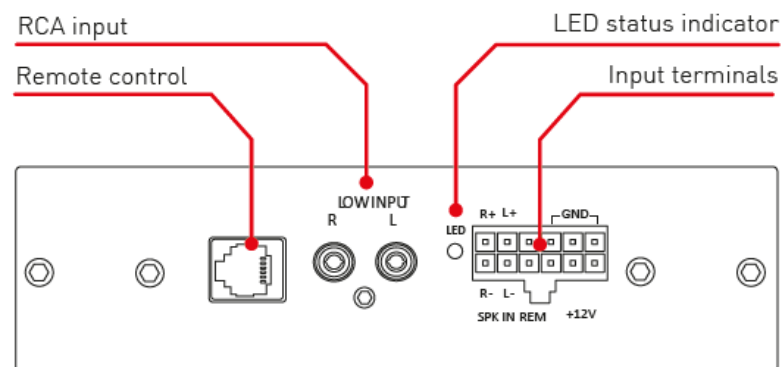
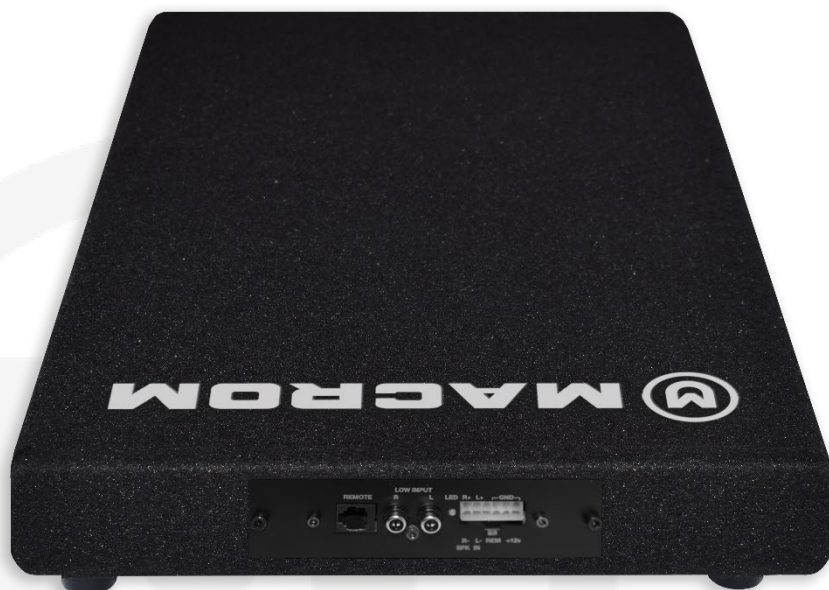

### Remote control view

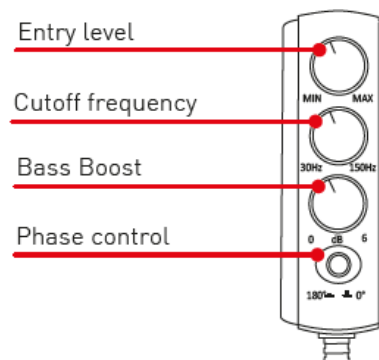



## M-SW250A 800W PEAK POWER



### Configurations

The connection panel on the back of the speaker provides easy access to the high-level or RCA inputs. Depending on the car's audio system, it is possible to determine the most appropriate audio input to manage the Subwoofer. The auto-sensing function automatically turns on the device without the aid of a remote control (+12V) from the radio.

RCA Ingresso

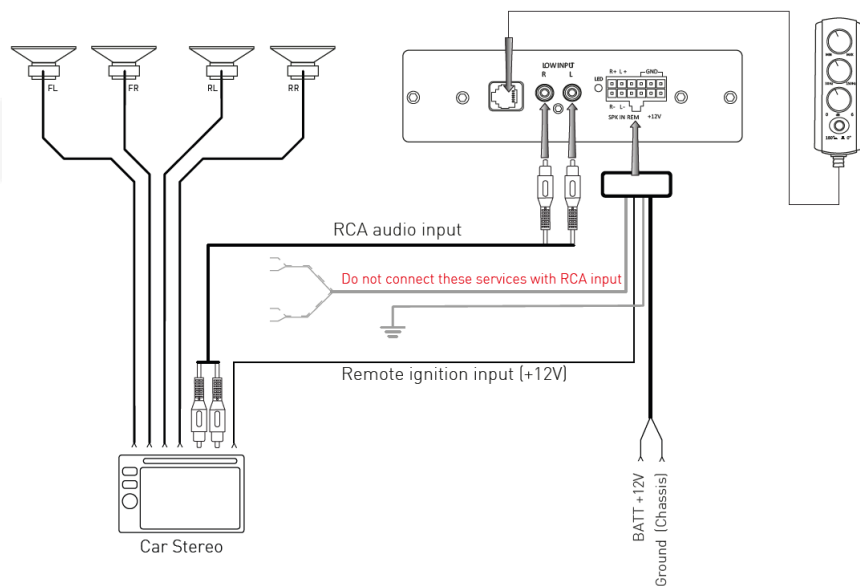

High level input

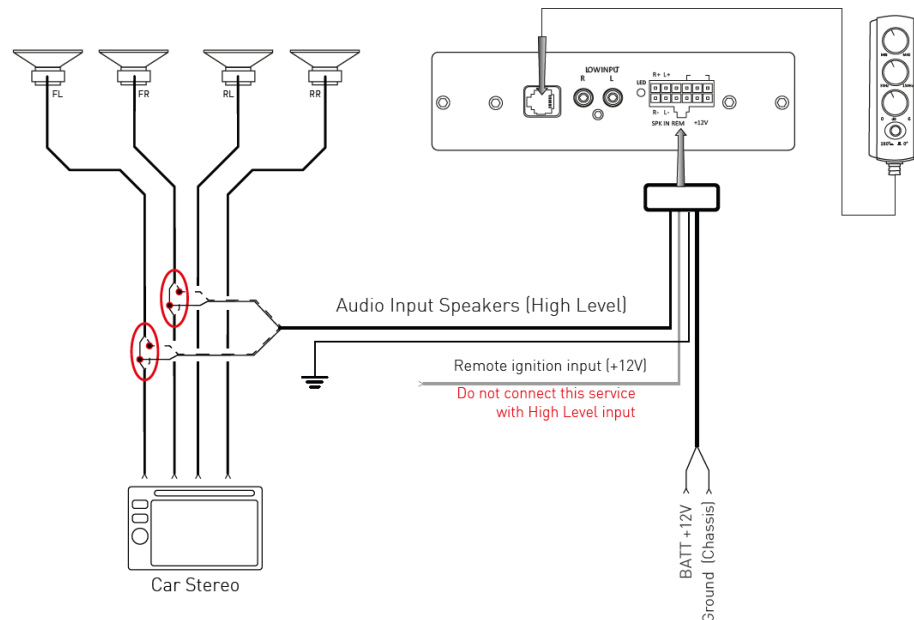



## M-SW250A 800W PEAK POWER



### ❑ Installation

Thanks to its small size (350 x 602 x H 78mm), installation is compact, immediate and offers great performance.

